

### ■ EURO MELAMINE SPECIFICATIONS

#### ■ LAMINATE SELECTIONS

- Selections from the Formica or WilsonArt Corporations. Refer to the selection charts in Laminate Section. Other laminates available upon special request and factory quotation.

#### ■ WOOD SPECIES - OPTIONAL UPGRADE

- Red birch, red oak, maple, cherry or paint (hardwood). Other species may be available on special request.

#### ■ INTERIOR SURFACES

- Choice of white or wood grain melamine.

#### ■ DOORS & DRAWER FRONTS - LAMINATE

- Choice of Formica or Wilson Art laminate selections or white melamine.
- 3/4" Furniture grade Medium Density particle board substrate.
- All edges are laminated with a matte finish, color coordinated PVC edging.

#### ■ DOORS & DRAWER FRONTS - WOOD

- Frames are solid lumber, 3/4" thick or thicker.
- Frames are joined by either a mortise and tenon which is additionally glued and pinned or a mitered construction which is doweled and glued for precision squareness.
- Center panels vary in thickness and material depending on styling.
- Stylings that require one piece construction may be 1 1/16" MDF (Medium Density Fiberboard)

### ■ DRAWERS

- 5/8" solid maple, sides, front, and back with eased top edges on all members for a furniture appearance. All are machined to receive the bottom.
- Dovetail joint construction on all four corners.
- 3/8" birch veneer plywood bottoms.
- BLUM tandem full extension under mounted with integrated soft close feature .
- Self adjusting, assuring proper alignment and operating very smoothly on nylon rollers.
- Exceptionally easy removal and replacement of drawers.
- 100 lb. load bearing capacity at full extension.

#### **Option - NO CHARGE - Must Specify**

- Blum Tandem Box - grey epoxy steel with full extension steel ball-bearing slides with intergrated soft close feature.

#### **Option - ADDITIONAL CHARGE - Must Specify**

- Blum Tandem Box - **Stainless Steel** with full extension steel ball bearing slides with intergrated soft close feature.

#### **Other**

- Some drawer accessories or unique cabinet depths may require different suspension systems.

**■ SHELVES**

- 3/4" thick white or woodgrain melamine on two sides.
- Matching white or woodgrain PVC laminated front edge banding
- 3 mm. steel furniture pins support shelves and adjust in a patterned height alignment in 32mm increments.
- 3 mm shelf holes are virtually obscure.
- Wall and tall cabinets have full depth shelves.
- Base cabinets have shelves two thirds the depth of the cabinet.

**■ FINISHED ENDS**

- 3/4" Furniture grade, medium density (45 lb.) particleboard with matching wood veneer, high pressure laminate choices, or white melamine on exterior. Interior surface is white or woodgrain melamine.
- WALL CABINET ENDS ARE 12 7/8" DEEP.
- BASE CABINET END ARE 23 7/8" DEEP.

**■ TOPS, BOTTOMS & UNFINISHED ENDS**

- 3/4" Furniture grade, medium density (45 lb.) particleboard.
- Interior surface is white or woodgrain melamine.
- All components are doweled and glued and precision squared in a press.
- All front case edges are laminated in a color coordinated PVC edging.
- Base cabinet tops are made full depth (except all sink, range bases, and vanity sink base cabinets) proving a fully sealed unit and a non-jamming top drawer regardless of contents.

**Up-grade Options**

- Cabinet front edges can be laminated with a matching, finished veneer or high pressure laminate for a 5% premium and must be indicated on the order.

**■ BACKS**

- 1/2" particleboard with white melamine or woodgrain interior.
- Backs are fit into machined grooves in both ends, tops and bottoms. They are glued & fastened.
- Thickness of backs allows attachment to wall at any desired location.

**■ TOE SPACES**

- 3" deep by 4 1/2" high.

**■ HINGING**

- BLUM 120 degree European fully concealed hinge with soft close.
- Due to corner, special applications, and interior options other hinging may be utilized.

**Up-grade Option**

- BLUM 170 degree, European fully concealed.
- Due to corner, special applications, and interior options other hinging may be utilized.

## ■ EURO WOOD SPECIFICATIONS

### ■ WOOD SPECIES

- Red birch, red oak, maple, cherry or paint grade (hardwood). Other wood may be available upon special request and will require additional lead time.

### ■ DOORS & DRAWER FRONTS

- Frames are solid lumber, 3/4" thick or thicker.
- Frames are joined by either a mortise and tenon which is additionally glued and pinned or a mitered construction which is doweled and glued for precision squareness.
- Centerpanels vary in thickness and material depending on styling.
- Stylings that require one piece construction may be 1 1/16" MDF (Medium Density Fiberboard)

### ■ DOORS & DRAWER FRONTS

- Frames are solid lumber, 3/4" thick or thicker.
- Frames are joined by either a mortise and tenon which is additionally glued and pinned or a mitered construction which is doweled and glued for precision squareness.
- Centerpanels vary in thickness and material depending on styling.

### ■ DRAWERS

- 5/8" solid maple, sides, front, and back with eased top edges on all members for a furniture appearance. All are machined to receive the bottom.
- Dovetail joint construction on all four corners.
- 3/8" birch veneer plywood bottoms.

## ■ DRAWER SUSPENSION

- BLUM tandem full extension under mounted with integrated soft close feature.
- Self adjusting, assuring proper alignment and operating very smoothly on nylon rollers.
- 100 lb. load bearing capacity at full extension.
- Some drawer accessories or unique cabinet depths may require different suspension systems.

### Option - NO CHARGE - Must Specify:

- BLUM Tandem Box - grey epoxy steel with full extension steel ball-bearing slides with integrated soft close feature.

### Up-grade Option - ADDITIONAL CHARGE Must Specify:

- BLUM Tandem Box - **Stainless Steel** with full extension steel ball bearing slides with integrated soft close feature.

## ■ SHELVES

- 3/4" thick plywood with finished, natural birch veneer on two sides
- Natural birch veneer PVC front edge banding
- 3 mm. steel furniture pegs support shelves and adjust in a patterned height alignment in 32 mm increments.
- 3 mm. peg holes are virtually obscure.
- Wall and tall cabinets have full depth shelves.
- Base cabinets have shelves two thirds the depth of the cabinet.

**■ FINISHED ENDS**

- 3/4" plywood with finished, matching veneer or high pressure laminate. Please refer to the finish selections in the following section.
- WALL CABINET ENDS ARE 12 7/8" DEEP.

**■ TOPS, BOTTOMS & UNFINISHED ENDS**

- 3/4" plywood veneered two sides. Interior side is birch veneer in a natural finish.
- All components are doweled and glued and precision squared in a press.
- All front case edges are laminated in a color coordinated PVC edging.
- WALL CABINET ENDS ARE 12 7/8" DEEP.
- Base cabinet tops are made full depth (except all range and sink bases) providing a fully sealed unit and a non-jamming top drawer regardless of contents.

**Up-grade Option:**

- Case edge with matching veneer or high pressure laminate.

**■ BACKS - FULL**

- 1/2" plywood. Interior side is birch veneer in a natural finish.
- Backs are fit into machined grooves in both ends, top and bottom. Backs are glued and fastened.
- Thickness of backs allows attachment to wall at any location desired.

**■ TOE SPACES**

- 3" deep by 4 1/2" high.

**■ HINGING**

- BLUM 120 degree, European fully concealed with intergrated soft close feature.
- Due to corner, special applications, and interior options other hinging may be utilized.

**UPGRADE:**

- BLUM 170 degree European fully concealed hinge. See cabinet modification sections.
- Due to corner, special applications, and interior options other hinging may be utilized.

### ■ TYPICAL CONSTRUCTION

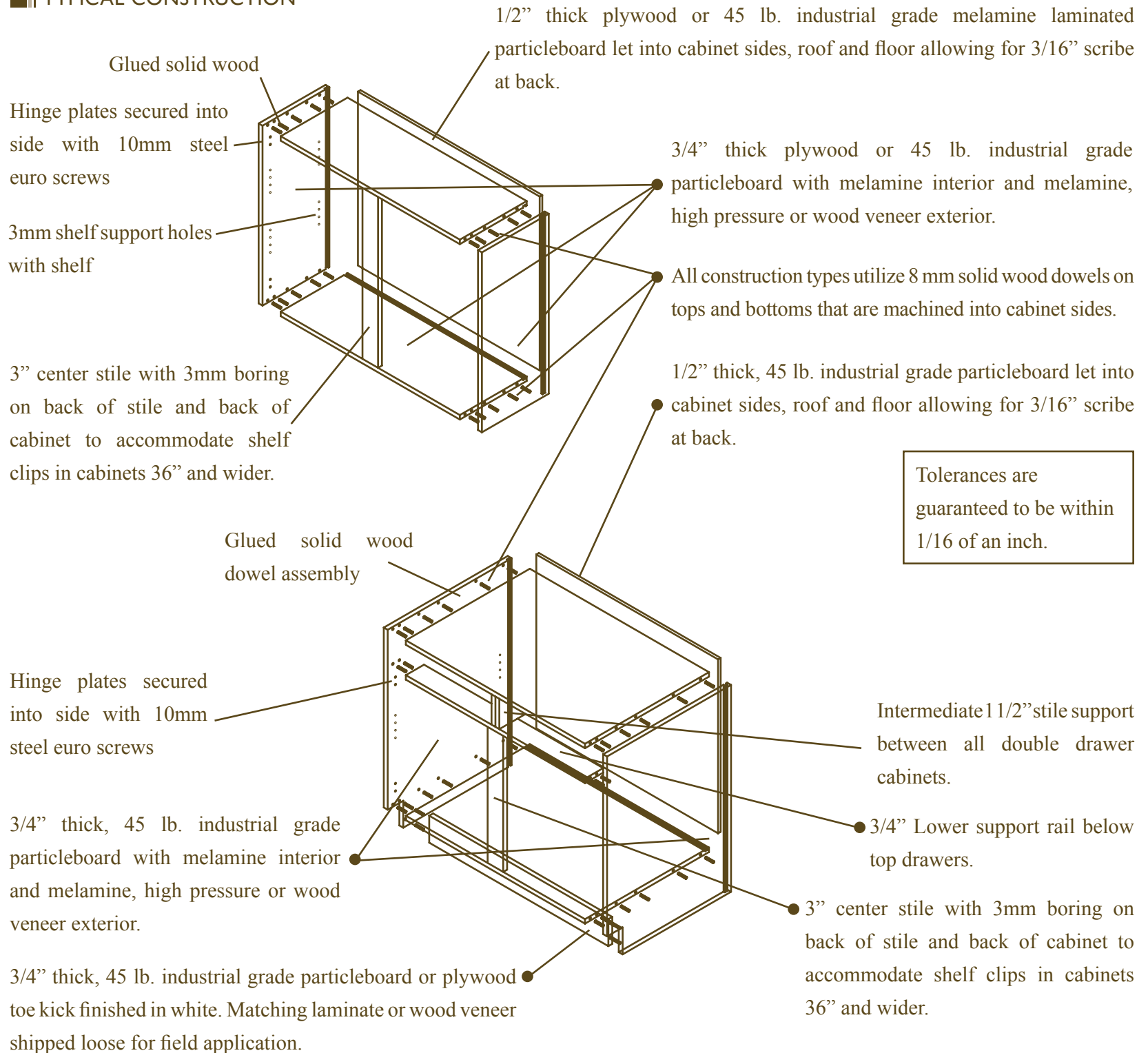

STANDARD ELEVATIONS

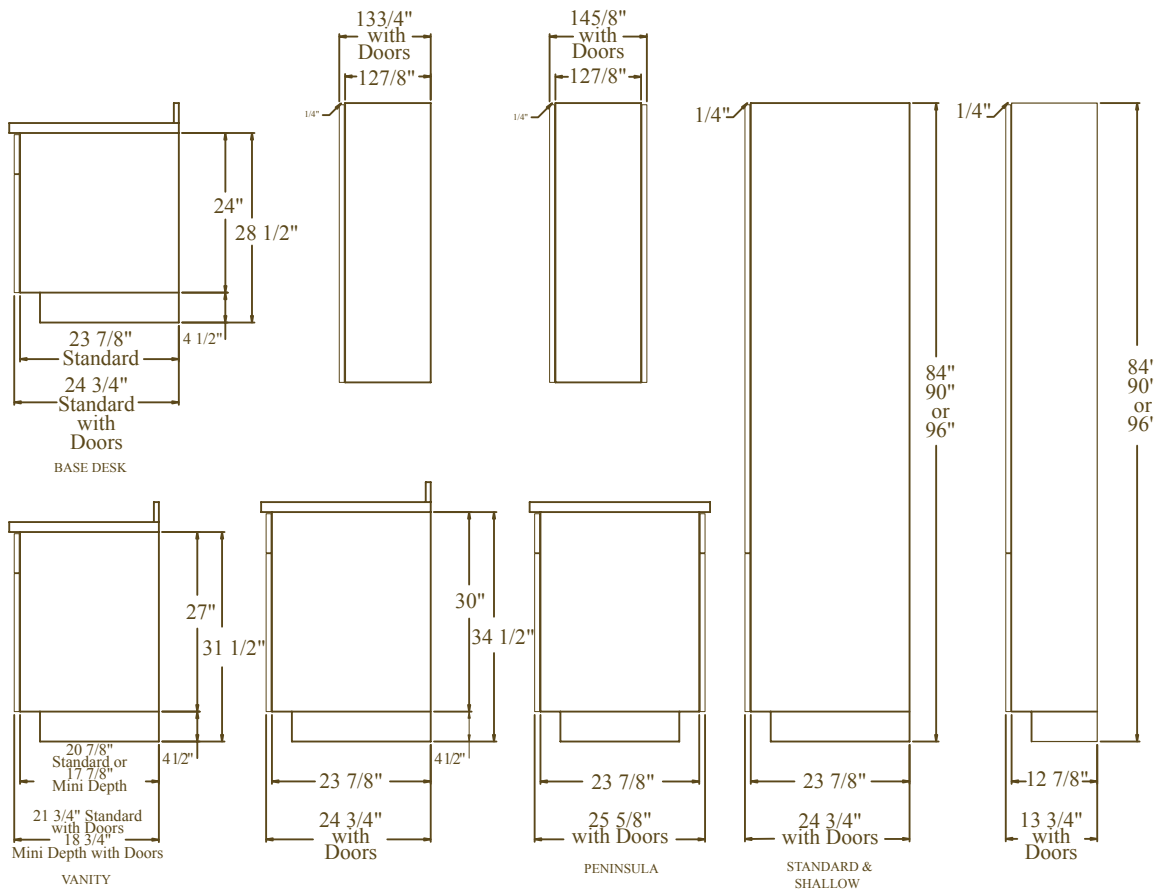
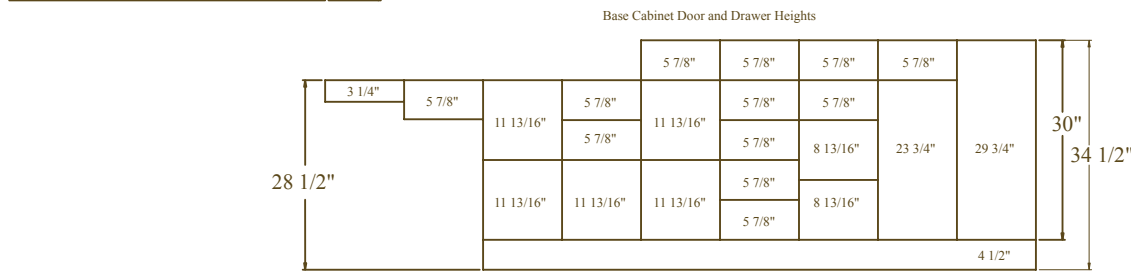
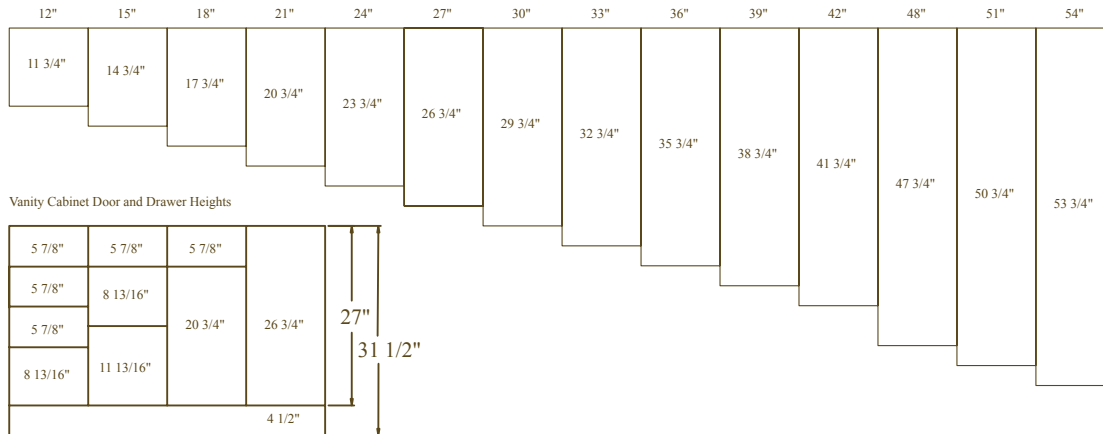

This guide sheet should be used to determine door and drawer alignments. Door and drawer head dimensions are nominal. Cabinet dimensions are imperial and not metric, which affords the designer size configurations consistent with domestic manufacturers. Base, wall, vanity and tall cabinet depth dimensions include doors and drawer heads.

Wood Drawer Box Sizes —  
Width = case width minus 1 7/8”  
Depth = 21”, 18”, 15”, 12”, or 9”  
depending on depth of cabinet,  
usually 3” less than overall  
cabinet depth.

### STANDARD TALL ELEVATIONS

84" HIGH	90" HIGH	93" HIGH	96" HIGH
14 3/4"	20 3/4"	23 3/4"	26 3/4"
40 1/2"	40 1/2"	40 1/2"	40 1/2"
23 3/4"	23 3/4"	23 3/4"	23 3/4"

Single Oven Cabinet

84" HIGH	90" HIGH	93" HIGH	96" HIGH
14 3/4"	20 3/4"	23 3/4"	26 3/4"
40 1/2"	40 1/2"	40 1/2"	40 1/2"
11 13/16"	11 13/16"	11 13/16"	11 13/16"
11 13/16"	11 13/16"	11 13/16"	11 13/16"

Single Oven Cabinet

84" HIGH	90" HIGH	93" HIGH	96" HIGH
14 3/4"	20 3/4"	23 3/4"	26 3/4"
55 1/2"	55 1/2"	55 1/2"	55 1/2"
8 13/16"	8 13/16"	8 13/16"	8 13/16"

Double Oven Cabinet

Please refer to Tall Section of Guide for minimum and maximum cutout dimensions.

For panels that require a larger cutout, a false drawer can be ordered in lieu of an active drawer.

84" HIGH	90" HIGH	93" HIGH	96" HIGH
49 3/8"	55 3/8"	58 3/8"	61 3/8"
5 7/8"	5 7/8"	5 7/8"	5 7/8"
11 13/16"	11 13/16"	11 13/16"	11 13/16"
11 13/16"	11 13/16"	11 13/16"	11 13/16"

Tall Butler Pantry

84" HIGH	90" HIGH	93" HIGH	96" HIGH
55 3/8"	61 3/8"	64 3/8"	67 3/8"
23 3/4"	23 3/4"	23 3/4"	23 3/4"

Tall Gourmet Storage

84" HIGH	90" HIGH	93" HIGH	96" HIGH
23 3/4"	29 3/4"	32 3/4"	35 3/4"
55 3/8"	55 3/8"	55 3/8"	55 3/8"

Standard Tall

**FIVE PIECE SOLID WOOD DOORS:** Are available as single raised panel on doors up to 44" high. All doors over 44" high will have two (2) equal sized raised panels excluding mitered corners. **WARPAGE GUARANTEE** Wood can expand and contract depending on the environment, changes in temperature or humidity or other such conditions. *QuakerMaid* offers a "limited guarantee" due to the above. Single panel raised panel doors offer a warpage limit of 3/16". Flat panel doors, frame only or mullion doors offer a warpage limit of 5/16" for single panel. Wider and/or taller doors (+26" wide x 44" tall) require two panels and the total warpage allowance is 5/16". "Single panel doors" that should be two panels (over the 26" OR 44") offer no guarantee.

■ ■ ■ FILLER AND CORNER DETAILS

BLIND BASE OR WALL CORNER DETAIL

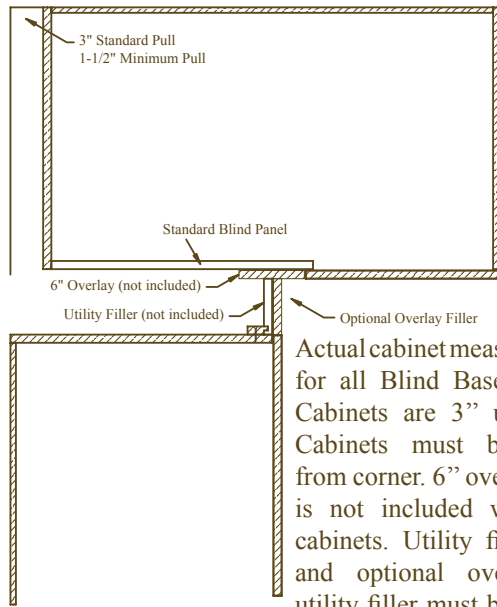

Actual cabinet measurements for all Blind Base & Wall Cabinets are 3" undersize. Cabinets must be pulled from corner. 6" overlay filler is not included with base cabinets. Utility filler (UF) and optional overlay for utility filler must be ordered separately.

■ ■ ■ PENINSULA BLIND BASE CORNER DETAIL

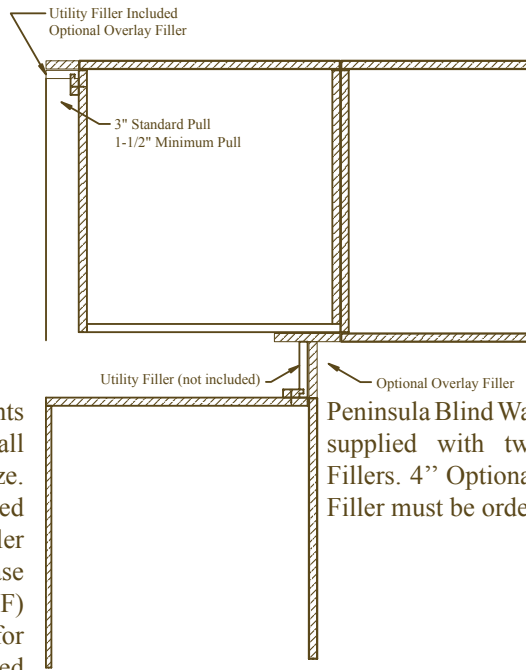

Peninsula Blind Wall Cabinet supplied with two Utility Fillers. 4" Optional Overlay Filler must be ordered

PENINSULA BLIND WALL CORNER DETAIL

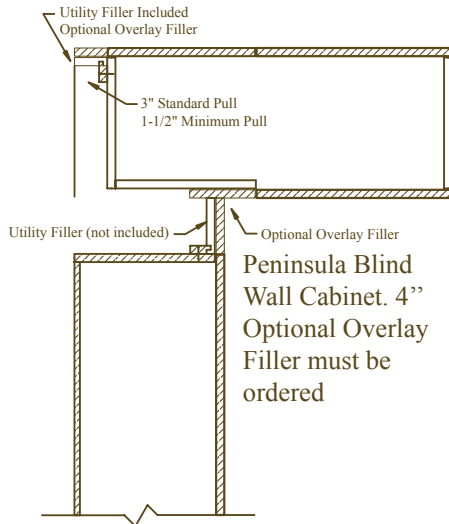

Peninsula Blind Wall Cabinet. 4" Optional Overlay Filler must be ordered

- Attach backer with screws to cabinet side prior to mounting cabinet with shoulder flush with box.
- Scribe filler to suit conditions after cabinet is mounted.
- Apply glue to groove and tap filler in place.
- Universal filler kit available without mounting.

Universal Filler Application

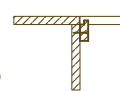

Universal Filler with Overlay Application

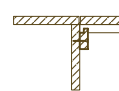

- Attach backer with screws to cabinet side prior to mounting cabinet with shoulder flush with box.
- Scribe filler to suit conditions after cabinet is mounted.
- Apply glue to groove and tap filler in place.
- Attach overlay filler.

BASE & WALL CORNER FILLERS

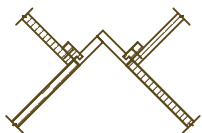

To form a 90 degree corner use two universal fillers. Fillers may be set back for overlay installation.

BASE & WALL CORNER FILLERS

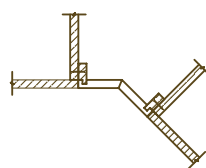

To form a 45 degree corner use two universal fillers and field cut to 45 degrees or irregular corner angles. Fillers may be set back for overlay installation.

DESIGN NOTE: If styled fillers are required they must be ordered and charged.



### ■ || EURO CORNER DETAILS

The following chart is supplied for your convenience in laying out corner installations of cabinets, ranges, dishwashers and ovens.

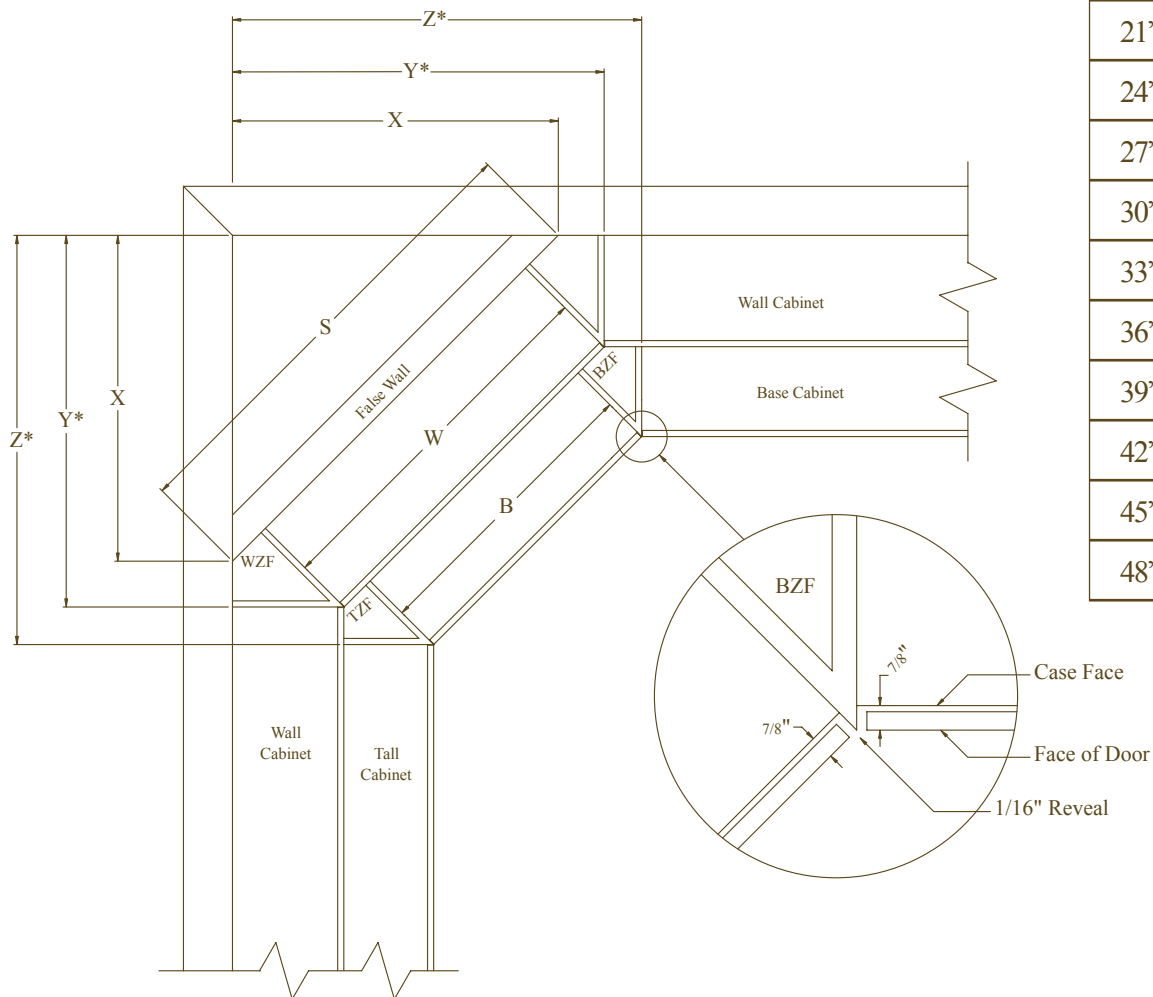

BASE CABINET		WALL CABINET		FALSE WALL	
B	Z	W	Y	S	X
Cabinet	From Corner	Cabinet	From Corner	Length	From Corner
12"	33 1/4"	21"	28 5/8"	32 3/8"	22 15/16"
15"	35 3/8"	24"	30 3/4"	35 3/8"	25
18"	37 1/2"	27"	32 13/16"	38 3/8"	27 1/8"
21"	39 5/8"	30"	34 15/16"	41 3/8"	29 1/4"
24"	41 3/4"	33"	37 1/16"	44 3/8"	31 3/8"
27"	43 13/16"	36"	39 3/16"	47 3/8"	33 1/2"
30"	45 15/16"	39"	41 5/16"	50 3/8"	35 5/8"
33"	48 1/8"	42"	43 7/16"	53 3/8"	37 3/4"
36"	50 3/16"	45"	45 9/16"	56 3/8"	39 7/8"
39"	52 5/16"	48"	47 11/16"	59 3/8"	42"
42"	54 7/16"	51"	49 13/16"	62 3/8"	44 1/8"
45"	56 9/16"	54"	51 15/16"	65 3/8"	46 1/4"
48"	58 11/16"	57"	54 1/16"	68 3/8"	48 3/8"

This diagram shows proper installation of a zero degree filler. To insure proper clearances, the point of the filler must be pulled flush with the front of cabinet doors and drawers.

\*Y and Z dimension includes angle filler thickness.

## DIAGONAL CORNER DETAILS

The following chart is supplied for your convenience for installations of corner cabinets. To assure proper door operation on diagonal cabinets we have increased the case side by  $3/16''$  of an inch. This results in a smooth door face and maintains proper reveals between cabinets. It is important to note that installation of any mouldings on wall cabinets where a diagonal cabinet is used, must have moulding applied to top of case because faces will not be flush with each other after installation.

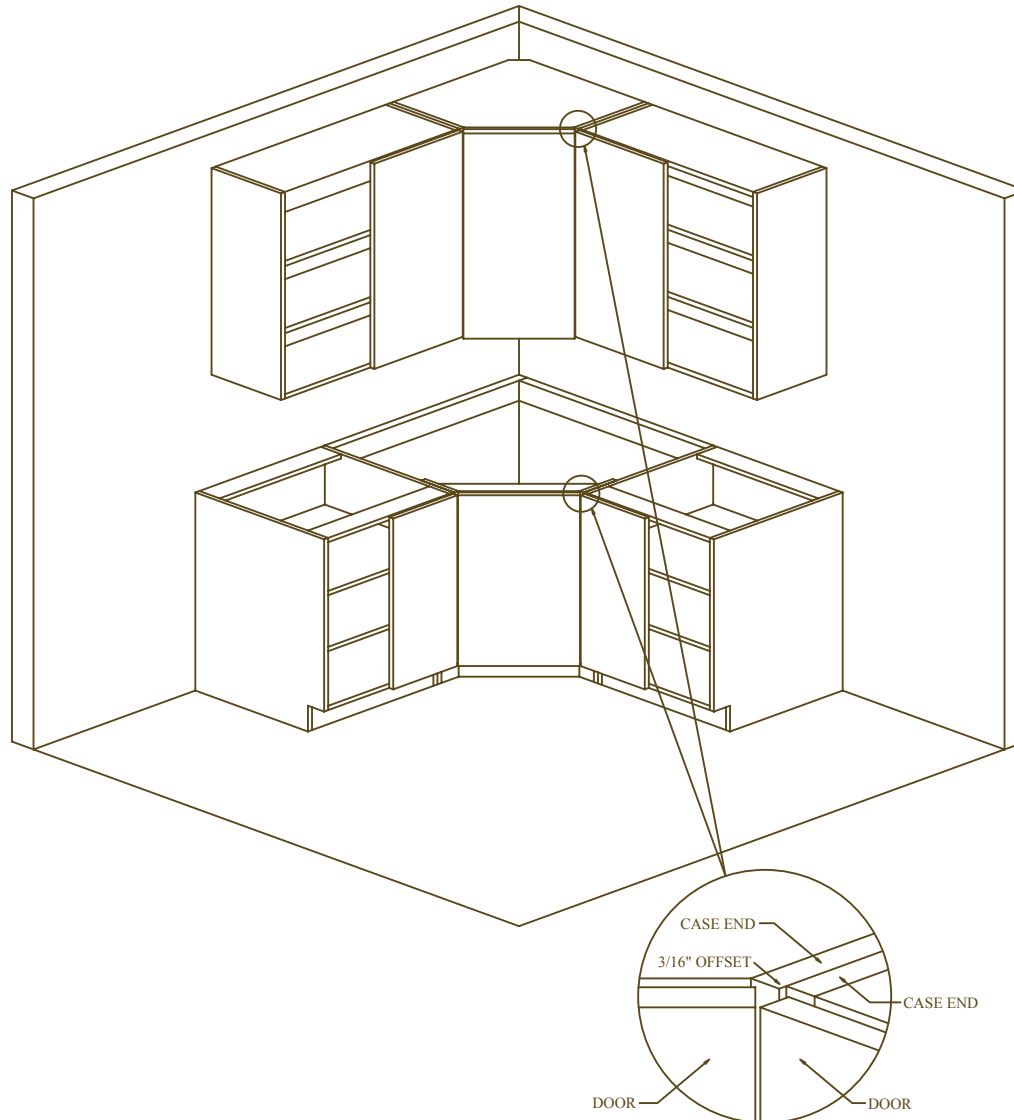

Diagonal Base and Wall Cabinets, and Diagonal Sink Front are engineered to be  $3/16''$  deeper than adjacent cabinets. See above detail. Therefore, in order to insure proper installation and function of these cabinets, cabinet **MUST** be installed as engineered. Any attempt to alter or deviate from this application will result in door binding against adjacent doors.

## ■ WOOD SELECTIONS

### **Paint Grade**

*QuakerMaid's* "Paint Grade" was developed for paint applications and will be comprised of--Hard Maple. This grade will allow all of the natural color range of the wood as well some stain and mineral. This product will not be matched for color and will have heartwood and sapwood present in varying amounts. Knots, wormholes and other defects that would cause voids are strictly limited, providing a smooth paintable surface.

Individual components of each product will be comprised of a mix of paint grade species. Products within the same order will also contain varying amounts of Hard Maple, Soft Maple and White Birch. This grade is intended for painting only.

### **Premium Grade Maple and Cherry - Euro**

*QuakerMaid's* "Premium" grade in Maple and Cherry has been developed for those Euro jobs where a more uniform look is needed. Premium grade will contain **less** of the natural material characteristics and is produced within a much narrower color range. This option will impact doors only. Items such as finished ends and panels will still be of the standard grade. Premium doors must be ordered to assure Premium grade on finished ends if desired.

Premium grade will contain fewer and smaller mineral streaks and knots than the "Standard" grade. Premium grade is intended to provide the consumer a job that is more consistent throughout for color and material characteristics. Premium Cherry will contain no sapwood on the face of the door.

### **Standard Grade Maple and Cherry - Euro**

*QuakerMaid's* "Standard" grade in Maple and Cherry is intended to meet a wide variety of applications. Standard grade allows for many of the natural characteristics of the wood to be present in the product while limiting or eliminating the most objectionable. Standard grade works well with most finishes. Lighter and clear finishes may tend to accentuate the natural color differences between the products. Standard grades door panels will be matched to assure a pleasing appearance. Colors will be blended within each door. Character marks such as knots and mineral streaks are strictly limited in size and amount in most species.

### **Tolerances**

Standard Grade Cherry - Sapwood will be limited on the face of Cherry doors but will be limited to the machined areas. Sound pin knots are permitted on the face of the doors. Mineral streaks of 3" in length and 1/4" wide may be found on the face of the doors. Sapwood may be found in varying degrees on the backs of the doors.

Standard Grade Maple - Pin and mineral streaks up to 3" in length and 1/4" wide (limited to 3 mineral streaks on a face of a door) are within tolerance. Heartwood may be found in varying degrees on the backs of the doors.

**Specie Red Birch-** This heavily and close-grained hardwood comes from the heart of the birch tree. Its wide color variation will evidence colors of chocolate to red to tan. This specie looks similar to cherry but does not darken dramatically to its exposure to sunlight. Red birch is considered beautiful in a natural finish.

**Red Oak-** Northern red oak is harvested in the upper New England area. Red oak is light tan with a pinkish tone and is consistently in this color range. Red oak is an opened grain, very strong hardwood. The grain pattern can vary from a close vertical grain to a wild cathedral shaped pattern. When stained, the grain becomes more pronounced and darker than the lighter areas.

**Hard Maple-** Harvested in the cooler climate of Canada, this is a close grained and lighter colored, off- brown to white hardwood. Maple is an excellent choice in lighter colored finishes but will appear “blotchy” in medium and dark finishes. Mineral streaks may appear and are inherent in maple that will also be accentuated by medium to dark finishes. *QuakerMaid’s* Velvet finish process will reduce the “blotching” but not eliminate it.

**Cherry-** Usually from northwestern Pennsylvania, cherry has a small amount of dark sap pockets and is reddish-brown in color. Cherry is a close-grained, medium density hardwood that darkens when exposed to light. The grain is generally distinguished by soft, smooth flowing cathedral patterns. Cherry will contain mineral streaks and small pinholes, which appear darker when stained.

**Paint Grade-** Paint grade can be the blend of several different hardwood species; hard maple, soft maple, and white birch. Paint grade may contain limitless color variation, however, because of the smoothness of these wood species, when covered by a solid color paint, are unnoticeable and perfect for painted cabinetry.

#### Wood Humidification

The natural response of any wood’s dimensional stability, to changes in humidity, is much more than one realizes. Take, for example, that old solid wood front door on a rainy day, which would always bind. There are changes that occur, for the most part unperceived, in the dimensional stability of any natural wood door with the changes in environmental humidity, primarily caused by seasons of the year. The following are good recommendations for your cabinetry and furniture: Watch the humidity. Reasonably accurate thermometer-hygrometer indicators are available from almost all hardware stores. Maintain humidity at or above 20% when the temperature is below 20 degrees Fahrenheit and over 35% when the temperature is above 20 degrees Fahrenheit.

Recognize that condensation on windows is a sign that the internal humidity levels are too high and recognize that wood takes several days to several weeks to react to humidity changes. Different wood species may react differently.

New construction sites are a problem for any natural wood product. Cabinetry should not be stored in any environment that is not fully enclosed and does not have the HVAC system on. Some new construction sites may meet this criteria, but with no one living there or checking the temperature and humidity, problems may still occur.

\* Finished ends and mouldings will have standard grade veneer. If

\*\* Includes heavy distressing at no charge.  
a Rustic end is desired a false door or wainscot end panel must be bordered.

## ■ FINISHING

*QuakerMaid* finishes are among the most consistent in the industry. Our hand wiping technique combined with the careful selection of color matched hardwoods ensures that your finish will be as consistent as possible. However, since the properties of wood are not consistent, we cannot ensure that each door will look exactly alike, nor can we guarantee that an order produced will match your initial sample swatch or door. Therefore, *QuakerMaid* does allow a range of color in its finished products. This acceptable color range may sometimes span several shades above or below the average shades for a stain and specie combination. As noted on the back of each color/stain block, *QuakerMaid* does not recommend placing an order for a finish from a color block. We strongly encourage that a sample door be ordered prior to ordering the job to ensure your customer's satisfaction. Please allow 10-14 working days after sign off for delivery of sample door.

**Hand Wiped Stains:** *QuakerMaid* stains use a time proven, hand wiped technique that delivers more color consistency and depth than simple spray stain applications. Prior to finishing, the wood is white wood sanded to a smooth, uniform surface. The stain is applied liberally over the surface of the wood and allowed to penetrate into the grain. The stain is then hand

wiped and dried. A protective, catalytic vinyl sealer is then applied. Once the sealer is dry, the wood is sanded to achieve a smooth surface for the topcoat. The wood is then topcoated using a catalytic conversion varnish. This topcoat is available in a Medium and Low Sheen. Our Medium Sheen is standard. If a Low Sheen is desired, *QuakerMaid* suggests that a sample be ordered in the desired wood and finish. NOTE: Application of Low Sheen finishes on softer woods, i.e. cherry, may result in a "starved" look on the finished product.

**Natural:** The application of catalyzed sealer and conversion varnish to natural wood. This exposes the wood specie's true character. Color variation in natural finishes on all wood species available, standard and/or premium grades, and NOT considered as imperfections NOR is it a reason for replacement. The natural and light finish disclaimer form must be signed.

**Maple:** Medium to darker stains on maple can appear somewhat mottled (blotchy) and uneven. This is a natural characteristic of the maple wood species and is not to be considered reason for product replacement.

## ■ SIGNATURE FINISHES

**Espresso** - This very dark brownish appearance is a special stain combination. Excellent as an accent color for stand alone cabinetry pieces, like a hutch, or to be that contrasting color for a unique exterior or interior of cabinetry with a lighter, complimenting finish. Not available on doors with “ME” edge.

**Harvest Velvet** - This opaque, light brown, special spray stain, obscures some of the natural tendencies of finishes on hardwoods. The primary example is its ability to mask (not eliminate) the blotching of Maple. **5% Upgrade**

**Harvest Velvet with a Glaze** - Available with the addition of White, Brown or Chocolate glaze. Harvest Velvet now even further obscures the wood variations and adds several choices of tonality accents.

**Merlot** - This unique and popular finish features a deep and dense colored Burgundy dye stain. Merlot has a rich and heavy (flat) appearance like paint and is almost opaque as the grain pattern is barely visible achieved by a process of hand wiping and toning. Red/Brown undertones. Not available on doors with “ME” edge.

**Old English** - This elevates tannery and takes it to the ultimate level some appear this is the perfect finish on maple.

**Tannery** - Some consider this finish the perfect medium brown appearance for cabinetry and furniture on Maple wood. It’s “leather-like” appearance creates a rich brown look without even a hint of red. **15% Upgrade**

## ■ PAINTED FINISH

**Joint Cracks:** Due to the fact wood is a material that continually expands and contracts in reactions to temperature and moisture levels, hairline cracks will most likely appear in the frame joints and door joints. This does not indicate weakness in the cabinet frame, door or finish. These cracks can be noticeable.

**Joint and Glue Line Movement:** Due to the wood reacting to temperature and moisture levels, glued up panels may more noticeably show glue lines (the seam where individual pieces of wood meet).

**Yellowing:** We use the most superior finish we can find. nevertheless, with white paint, there will be some yellowing over time. *QuakerMaid* Cabinetry cannot guarantee against yellowing. Therefore, *QuakerMaid* requires that a “Consumer Information Form” for painted wood be signed prior to an order being placed into production. Refer to last three pages of this section.

### What is Painted?

- All doors and drawer fronts, FRONT AND BACK
- Cabinets have coordinating PVC edgetape
- All finished ends
- All applied finished end panels. EXPOSED

#### SURFACES ONLY\*

- Finished Interiors - If finished interior are desired they must be ordered on each cabinet
- All trim, moulding and toekick material. EXPOSED SURFACES ONLY\*

**Paint:** Painted Finishes on wood are one of the most popular cabinet finishes available. *QuakerMaid* Cabinetry has taken great care to provide a durable painted finish. As a purchaser of painted cabinets, you need to fully understand that there are certain characteristics of painted wood present due to the nature of the wood in combination with the finish. These characteristics can cause some or all of the following conditions.

**NOTE:** All interior surfaces of “plywood” cabinetry and wood drawer boxes are sealed and topcoated for protection. All unexposed surfaces of appliance panels are sealed only. No paint is applied.

**NOTE:** Hairline cracks in wood joints; front frame and doors may appear over time. This is not a defect and is the natural tendency of wood exchanging moisture with its environment. Solid and light colors will accentuate this appearance.

## ■ GLAZE FINISHES

**Glaze Finishes:** *QuakerMaid* standard glaze “Hang-up” is light to medium. Since the glazing process is a matter of “taste”, every cabinet user will have a differing view on what is the ideal amount of glaze build-up on the wood surface, in particular, doors. Therefore, we strongly recommend that you order a door in the actual glaze to insure customer satisfaction. *QuakerMaid* maintains strict standards for its glazing process. As a result, we do not offer “custom” glaze on a job. Even if a sample door is ordered, *QuakerMaid* will not be held responsible to replace any product that is unsatisfactory to your customer due to the amount or degree of glaze “Hang-up”. *QuakerMaid* considers each door an original work of art and is subject to artistic impressions.

### Glazes available on most stained and painted finishes.

All Glaze orders must be ordered from a sample door in the exact style and wood specie requested.

### What is Glazed?

- All doors and drawer fronts, FRONT AND BACK
- Cabinets have coordinating PVC edgetape.
- All finished ends
- All applied finished end panels. EXPOSED SURFACES ONLY\*
- All open for glass cabinet interiors, including backs of doors and adjustable shelves.
- All trim, moulding and toekick material, EXPOSED SURFACES ONLY\*

Glazing is the hand application of a lighter or darker colored, resin-based coating applied over stains or paints to create an “Artistic” appearance. A catalyzed sealer and conversion varnish protect the finish.

Glazing is a hand process, therefore, there will be variations from door to door and the rest of the pieces in the installed job. *QuakerMaid* considers this acceptable.

### Custom Color Match - \$1300 List

**Custom Stains:** *QuakerMaid* will match any stain color within a reasonable range with respect to wood variations and natural mellowing for a premium on any order. Dealers must call customer service to obtain an RGA# and submit a sample to the factory for use as a match. A sample match will be produced and submitted to the dealer for approval.

**Custom Paints:** *QuakerMaid* will match any paint color within a reasonable range with respect to wood variations and natural mellowing for a premium on any order. This upcharge applies to all cabinets, doors, drawers and accessories. Dealers must call customer service to obtain an RGA# and submit a sample to the factory for use as a match. Sample match will be produced and submitted to the dealer for approval.

Dealer must submit a sample of any special finish. Three color blocks will be sent for approval and one must be signed and returned. A sample front will be sent in the style and finish requested. All finish process premium charges apply to the order.

- An RTV must be issued for factory to accept dealer supplied match.
- Factory will determine species and color from RTV.
- A sample door will be produced for Dealer/Customer Approval
- \$1300.00 List - This is the cost to produce the sample and has no bearing on the order other than a reference point.



- Dealer must submit the Custom Finish or Custom Distressing Acceptance Form.
- Dealer and customer must sign the door sample label and fax to factory as acceptance.
- No orders will be scheduled for production without signed approval.

### Finish Descriptions and Charges

#### Unfinished Cabinetry - Deduct 5%

Cabinetry with no finish on either exterior or interior - cabinetry is sanded to accept finish in the field. Unfinished cabinetry is NOT GUARANTEED under *QuakerMaid's* Lifetime Limited Warranty.

#### Primed Exterior - No additional charge

Cabinetry that will have a custom paint applied at the job site can be shipped with a primed exterior and a standard interior.

**Note: Unfinished products are NOT GUARANTEED under the Limited Lifetime Warranty.**

**Standard Exterior Sheen** - No additional charge The standard exterior sheen on all Quakermaid cabinetry is as follows:

- Stained Products - Medium Sheen
- Painted Products - Medium Sheen
- Glazed Products - Low Sheen

Both Medium and Low Sheen Top Coatings provide the same excellent protection. Low Sheen dries to approximately a 10-degree gloss and Medium Sheen dries to approximately a 30-degree gloss. Medium Sheen is considered the typical sheen found on most furniture products. Low Sheen, blends well, and it considered more compatible with Glazed products that take on a somewhat "Artistic" appearance.

**Fly Specking** - 10% upgrade. Fly specking is the hand application of very small, dark specks to the stain or painted finish. Fly specking is applied before the final topcoat. Actual product samples must be viewed before ordering this application. The final appearance is considered an "Old World" effect.

### ■ RUB THROUGH

Euro - 7%

This process simulates wear of a finish over many years. Actually, the edges are lightly sanded until the natural wood shows through. This sanding process is done after the color coating, but before the final, protective top coating. This process is NOT applied to unexposed surfaces. An actual door sample of this process must be viewed before ordering. Not available in Paint Grade.

Rub Through

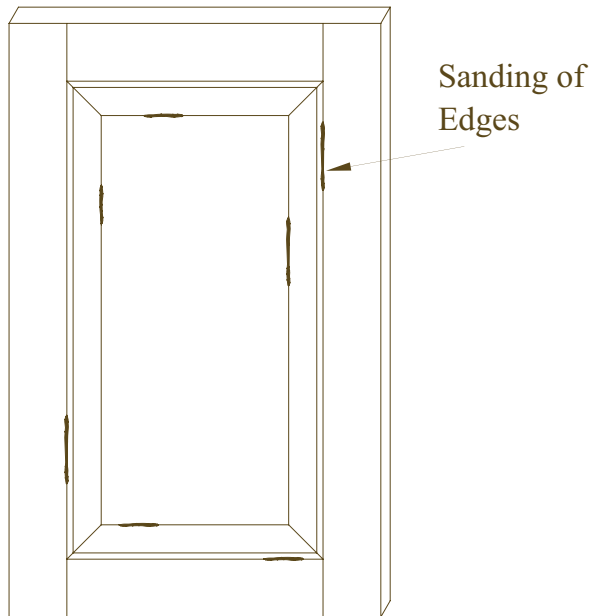

### ■ LIGHT DISTRESSING

Euro - 10%

Softening (light sanding) of corners of doors and raised panels. All sanding is done prior to the final color coating but before the final protective topcoating. Light distressing will only be applied to exposed surfaces. An actual door sample of this process must be viewed before ordering.

Light Distressing

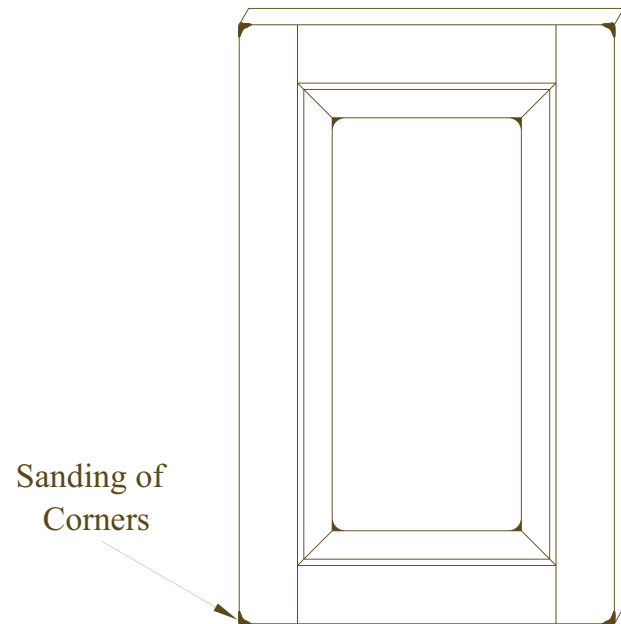

#### WHAT IS DISTRESSED?

- All doors and drawer fronts, FRONT ONLY.
- All cabinet faces
- All finished ends
- All applied finished end panels. EXPOSED SURFACES ONLY\*

- All trim, moulding and toekick material, EXPOSED SURFACES ONLY\*
- \*EXPOSED SURFACES are defined as any surface that can be seen when the doors are closed

### HEAVY DISTRESSING

Euro - 12%

Heavy Distressing has all the applications of Light Distressing with the addition of cracks and splits (every second or third door or cabinet), worm holes, gouges, and nicks and dents. Heavy distressing will only be applied to exposed surfaces and is always used on Knotty Pine in *QuakerMaid's* traditional cabinetry at no additional charge. An actual door sample of this process must be viewed before ordering.

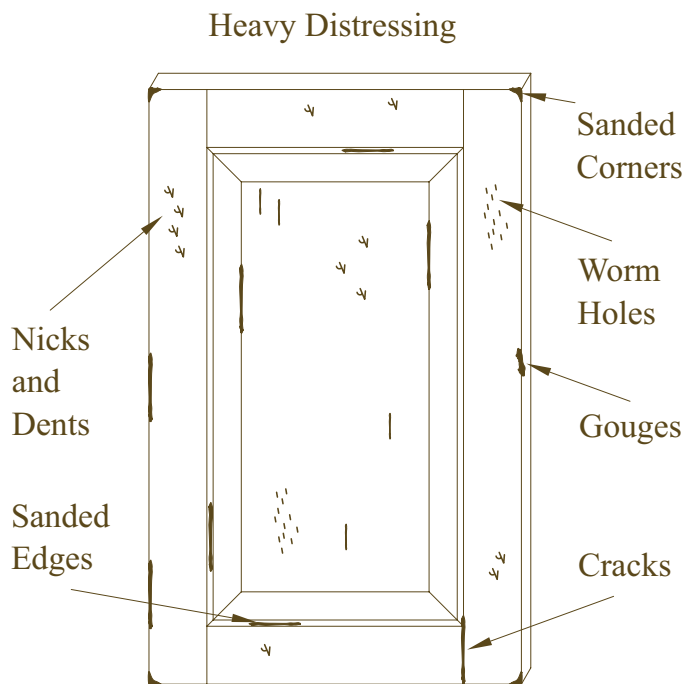

### SMASHED CORNERS

Euro - 7%

Corners of all doors and corners of all raised panels in doors (if applicable) are heavily sanded and rounded down. Add this process with RUB THROUGH for the ultimate “worn” appearance. An actual door sample of this process must be viewed before ordering.

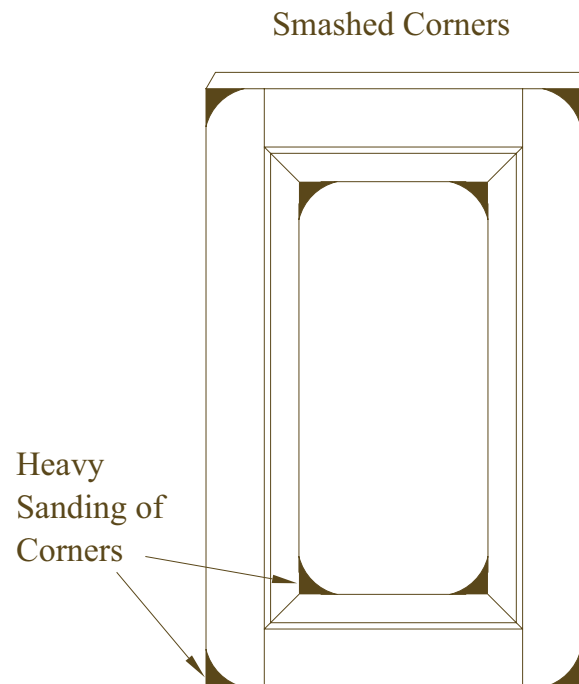

## ■ LAMINATES, FOILS, EXOTICS

	FORMICA LAMINATE COLOR	MATTE	GLOSS
	<b>FORMICA® SELECTION CHART</b>	<b>SOLIDS</b>	
ALMOND		920	920-90
ANTIQUÉ WHITE		932	932-90
BEIGE		958	N/A
BIRCH		921	N/A
BLACK		909	909-90
BRITE WHITE		459	459-90
CHAMPAGNE		925	N/A
FOG		961	961-90
FOLKSTONE		927	927-90
GRAPHITE		837	N/A
GRAYSTONE		464	N/A
HUNTER GREEN		967	N/A
IVORY		460	N/A
MISSION WHITE		933	N/A
OYSTER GRAY		929	N/A
PEARL		934	N/A
PLATINUM		902	N/A
PUMICE		858	N/A
SAIL WHITE		463	463-90
SPECTRUM BLUE		851	N/A
SURF		923	N/A
WHITE		949	949-90
<b>PATTERNS</b>			
ANTIQUÉ WHITE PAPER CRAFT		663	N/A
BEIGE GRAFIX		506	N/A
BLUE SILK GRAPHIX		522	N/A
CONCRETE STONE		7267	N/A
DENIM CANVAS		7268	N/A
GRAY CANVAS		7023	N/A
NATURAL CANVAS		7022	N/A
NAVY BLUE		969	N/A
NAVY GRAFIX	7018	N/A	

### ■ STANDARD LAMINATE DOORS & DRAWERS

All door and drawer edges will be finished in a coordinating matte PVC edge color. For patterns and woodgrain please select a solid matte PVC edge color choice from the solid color selections. Melamine finished ends are at no charge in white.

Back of doors match door face. If a non-standard laminate color is required, contact Customer Service for quote.

\*Premium upcharge is on the entire order including: cabinets, doors, mouldings, etc.

### MATCHING HIGH PRESSURE LAMINATE CASE EDGES

### MATCHING HIGH PRESSURE LAMINATE DOOR AND DRAWER FRONT EDGES -

All Are:  
Wilsonart  
or  
Formica

FORMICA® SELECTION CHART	FORMICA LAMINATE COLOR	MATTE	GLOSS
	<b>WOOD GRAINS</b>		
	ACAJOU MAHOGANY	7008	N/A
	AFRICAN LIMBA	7011	N/A
	ALMOND EMBOSSED WOODGRAIN	920-25	N/A
	AMBER MAPLE	7012	7012-90
	BLACK EMBOSSED WOODGRAIN	909-25	N/A
	BLOSSOM CHERRY	758	N/A
	CHERRY BIRCH	7484	N/A
	CHESTNUT BURL	N/A	1136-90
	COLONIAL CHERRY	117	N/A
	FINNISH OAK	118	N/A
	GINGER ROOT MAPLE	7288	7788-90
	GOLDEN BIRDSEYE	N/A	N/A
	LACEWOOD	744	744-90
	NATURAL BIRCH	7481	N/A
	NATURAL MAPLE	756	N/A
	NATURAL OAK	346	N/A
	NORTHERN OAK	7152	N/A
	SELECT CHERRY	7759	N/A
	VICTORIAN MAHOGANY	7583	N/A
	VIOLIN FIGURED ANNIGRE	7285	N/A
	VOSGES PEAR	1150-43 <sup>1</sup>	N/A
	WILD CHERRY	5904	N/A

#### ■ STANDARD LAMINATE DOORS & DRAWERS

All door and drawer edges will be finished in a coordinating matte PVC edge color. For patterns and woodgrain please select a solid matte PVC edge color choice from the solid color selections. Melamine finished ends are at no charge in white. Back of doors match door face.

If a non-standard laminate color is required, contact Customer Service for quote.

\*Premium upcharge is on the entire order including: cabinets, doors, mouldings, etc.

#### MATCHING HIGH PRESSURE LAMINATE CASE EDGES

#### MATCHING HIGH PRESSURE LAMINATE DOOR AND DRAWER FRONT EDGES

	PREMIUM LAMINATE COLLECTION	MATTE	GLOSS
	WILSONART® LAMINATE COLLECTION	<b>SOLIDS</b>	
ALABASTER		D431-60	D431-1
ANTIQUE WHITE		1572-60	1572-1
BLACK		1595-60	1595-1
DESIGNER WHITE		D354-60	D354-1
DOVE GRAY		D92-60	D92-1
FASHION GRAY		D381-60	D381-1
FROSTY WHITE		1573-60	1573-1
GREY		1500N-60	1500-1
LIGHT BEIGE		1531-60	1531-1
NATURAL ALMOND		D30-60	D30-1
PLATINUM		D315-60	D315-1
<b>PATTERNS</b>			
BEIGE PAMPAS		4170-60	N/A
CLOUD NEBULA		4630-60	N/A
EBONY STAR		4552-60	N/A
GRAPHITE NEBULA		4623-60	N/A
GRAY GLACE		4142-60	N/A
GRAY NEBULA		4622-60	N/A
GRAY PAMPAS		4168-60	N/A
HUNTER NEBULA		4627-60	N/A
NATURAL NEBULA		4633-60	N/A
NEUTRAL GLACE		4143-60	N/A
SAND NEBULA		4628-60	N/A
TEAL NEBULA		4632-60	N/A
WHITE NEBULA		4621-60	N/A
WHITE SUEDE		2904-60	N/A
VERDI POMPEII		N/A	1741-1
<b>WOOD GRAINS</b>			
BANISTER OAK		7806-60	N/A
FUSION MAPLE		7909-60	N/A
SANIBEL MAPLE		7908-60	N/A

### QUAKERMAID SELECTED THESE WILSONART® LAMINATES AS OUR PREMIUM COLLECTION

#### ■ STANDARD LAMINATE DOORS & DRAWERS

All door and drawer edges will be finished in a coordinating matte PVC edge color. For patterns and woodgrain please select a solid matte PVC edge color choice from the solid color selections. Melamine finished ends are at no charge in white. Back of doors match door face.

If a non-standard laminate color is required, contact Customer Service for quote.

\*Premium upcharge is on the entire order including: cabinets, doors, mouldings, etc.

#### MATCHING HIGH PRESSURE LAMINATE CASE EDGES

#### MATCHING HIGH PRESSURE LAMINATE DOOR AND DRAWER FRONT EDGES

## TREVISO SELECTION CHART

COLOR	FINISH	NUMBER
<b>SOLIDO GLOSS</b>		
BLANCA	GLOSS	080Z
CAPPUCHINO	GLOSS	280Z
MAROON	GLOSS	231Z
NERO	GLOSS	100Z
<b>SOLIDO SATIN</b>		
BISQUE	MATTE	380Z
NERO SATIN	SATIN	600Z
BIANCA SATIN	MATTE	620Z
<b>BRILLARE</b>		
BRILLARE BIANCA	GLOSS	181Z
BRILLARE CHARCOAL GRAY	GLOSS	581Z
BRILLARE CREAM	GLOSS	583Z
BRILLARE GREY BLUE	GLOSS	197Z
BRILLARE GREY WHITE	GLOSS	930Z
BRILLARE MAROON	GLOSS	851Z
BRILLARE MIDNIGHT BLUE	GLOSS	630Z
BRILLARE NERO	GLOSS	490Z
BRILLARE OFF WHITE	GLOSS	980Z
BRILLARE VIBRANT ORANGE	GLOSS	610Z
<b>LEGNO GLOSS</b>		
HARD ROCK MAPLE	GLOSS	420Z
DARK EBONY	GLOSS	900Z
FRIZZLY	GLOSS	800Z
PEAR	GLOSS	246Z
RED EBONY	GLOSS	550Z
SUGAR MAPLE	GLOSS	770Z
SUMMER CHERRY	GLOSS	430Z
ZEBRAWOOD LIGHT	GLOSS	720Z
<b>LEGNO MATTE</b>		
LIGHT BEECH	MATTE	510Z
NATURAL ALDER	MATTE	011Z
RIGATINO GIALLO	EMBOSSED	310Z
SATIN VANILLA CHERRY	SATIN	780Z
STEAMED BEECH	SATIN	110Z
TIROL SLICED BEECH	SATIN	050Z
TEAK	EMBOSSED	733Z
TRAVERTINE HORIZONTAL OAK	SATIN	290Z
WENGE	EMBOSSED	282Z
ESPRESSO SILVER OAK	MATTE	760Z
<b>METALLICA</b>		
BRUSHED ALU BLUE	METALLIC	800Z
BRUSHED ALU SILVER	METALLIC	780Z
METALLIC BLUE	METALLIC	548Z
STAINLESS STEEL	METALLIC	090Z

Treviso foil doors will have matching case edges as standard. Matching finished ends are available at an up-charge. See modification section for up-charge.

## EXOTICS SELECTION CHART

EXOTIC WOOD SPECIE	CUT
JATOBA	Plain Sliced
SAPELE	Ribbon
EURO STEAMED BEECH	Quartered
BLACK WALNUT	Plain Sliced
WHITE OAK	Rift
AMERICAN BLACK CHERRY	Quartered
LACEWOOD	Quartered
SUCUPIRA	Plain Sliced
ZEBRAWOOD	Rift
FIGURED ANIGRE	Quartered
SANTOS ROSEWOOD	Plain Sliced
FIGURED ENGLISH SYCAMORE	Quartered

PALERMO VERTICAL GRAIN	NAPLES HORIZONTAL GRAIN
YES	N/A
YES	N/A
YES	YES
YES	N/A
YES	YES
YES	N/A
YES	N/A
YES	N/A
YES	YES
YES	N/A
YES	N/A
YES	N/A
YES	N/A
YES	N/A

- Palermo and Naples door styles will have “Similar” specie edges on door and drawer parts. Example Sapele will have Mahogany edges.
- Case edges will have coordinating PVC or wood veneer.
- Backs of doors will have a coordinating veneer of the same or similar wood species.



WOOD,  
FINISHING & DOORS  
  
 LIGNA SELECTION CHART

	LIGNA	NUMBER	PATTERN
	<b>MODERN VENEERS</b>		
	BLOND FINELINE	8428	STRAIGHT-LINE GRAIN
	PEAR FINELINE (WENGE)	8429	STRAIGHT-LINE GRAIN
	KOFFE FINELINE	8430	STRAIGHT-LINE GRAIN
	MAPLE STRIAWOOD	8431	RIFT-CUT
	OAK	8435	RIFT-CUT
	RUM CHERRY STRIAWOOD	8433	RIFT-CUT
	MOCHA STRIAWOOD	8434	RIFT-CUT
	<b>TRADITIONAL VENEERS</b>		
	GRAND MAHAGONY	8438	RIFT-CUT
	MAPLE	8439	CATHEDRAL
	BIRCH	8440	CATHEDRAL
	FRUITWOOD	8441	CATHEDRAL
	APPLEWOOD	8442	CATHEDRAL
	CHERRY	8443	CATHEDRAL
	RUM CHERRY	8444	CATHEDRAL
	<b>METRO VENEERS</b>		
	ZEBRA WOOD	8453	STRAIGHT-LINE GRAIN
	ISLAND TEAK	8454	STRAIGHT-LINE GRAIN
	EBONY	8455	STRAIGHT-LINE GRAIN
	<b>CLASSIC VENEERS</b>		
	CHERRY	8436	CATHEDRAL
	OAK	8437	CATHEDRAL
	WALNUT	8445	CATHEDRAL
	<b>EXOTIC VENEERS</b>		
	BIRDSEYE MAPLE	8446	BIRDSEYE
	CHERRY BIRDSEYE	8448	BIRDSEYE
	BOMBAY BAMBOO	8456	FLAT-CUT
	FLAXEN BAMBOO	8457	RIBBON-CUT
	CARMELIZED BAMBOO	8458	RIBBON-CUT

- Ligna orders will have matching case, door and drawer edge finish as standard. Matching finished backs of doors to door faces available at an upcharge – refer Ligna and Ligna Novanta door pages.

■ MORTISE & TENON DOOR OPTIONS

**Exterior Lip Edge Options - Raised and Recessed Panel Doors**

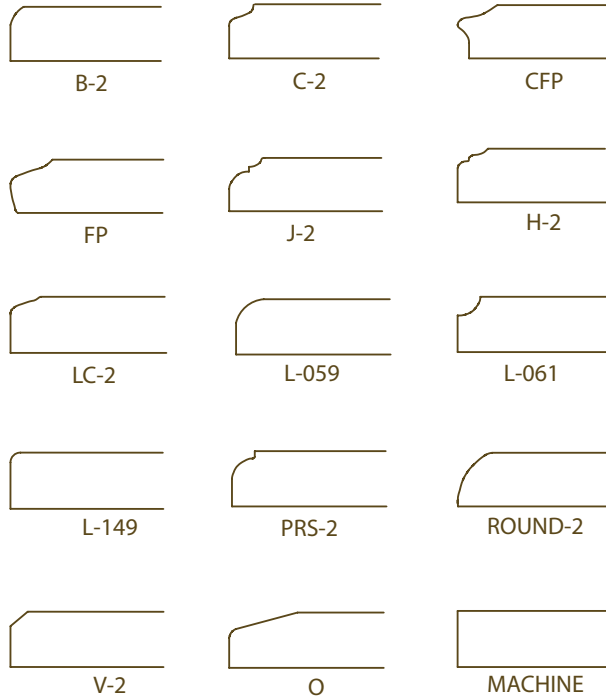

**Interior Frame Bead Options - Raised and Recessed Panel Doors**

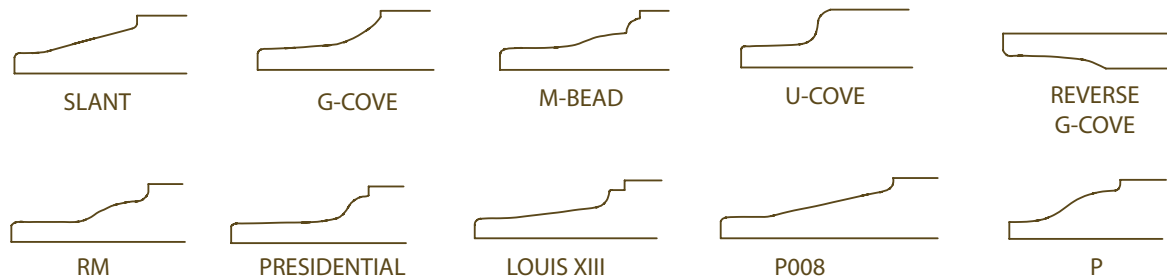

**Center Panel Raise Options - Raised Panel Doors Only**



## ■ || NORFOLK

PLAIN

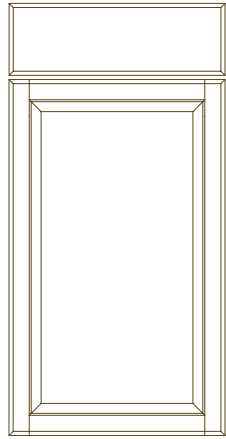

RAISED

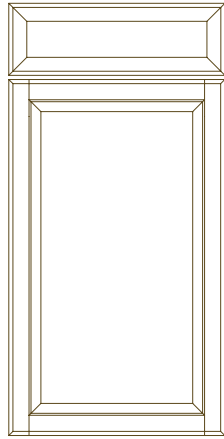

STYLED

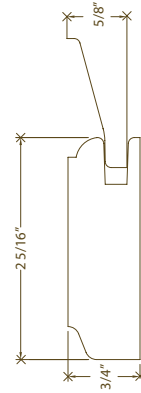
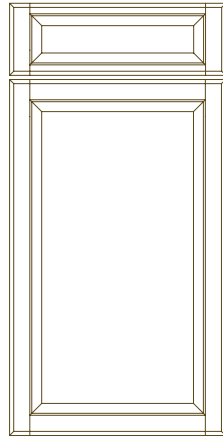

### ■ Features:

Lip: C-2  
Raise: Slant  
Bead: REG

### ■ Construction Features:

Mortise & Tenon Joint  
Center Panel: Raised, 5/8"  
Thickness: 3/4"  
Stiles: 2 5/16"  
Rails: 2 5/16"

### ■ Sizes Constraints:

Door Min.: 7-1/2" W x 7-1/2" H

Styled Drawer Min.: 7-1/2" W x 5-7/8" H (Stiles: 2-5/16", Rails: 1-1/2")

Doors less than 7 1/2" W will be a 3/4" thick solid wood flat slab with profiled edges.

Doors over 48" high will have two panels. Door premiums will be charged per each panel.

### ■ Glass Door and Mullion Styling: Available

### ■ Available on radius and Z door cabinets.

### EURO

	Plain	Raised	Styled
■ PRICE: Drawers	NC	\$28	\$40
■ PRICE: Doors	\$15		

## ■ || LOUIS XIII

PLAIN

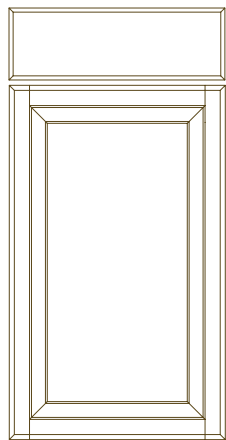

STYLED

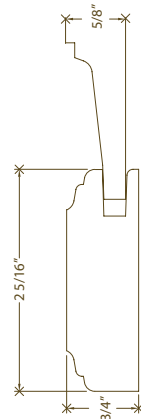
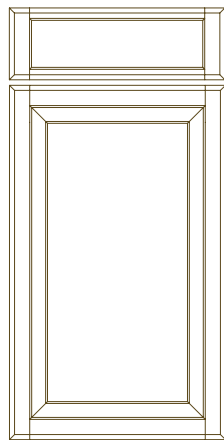

### ■ Features:

Lip: standard  
Raise: standard  
Bead: standard

### ■ Construction Features:

Mortise & Tenon Joint  
Center Panel: Raised, 5/8"  
Thickness: 3/4"  
Stiles: 2 5/16"  
Rails: 2 5/16"

### ■ Size Constraints:

Door Min: 7 1/2" W x 7 1/2" H

Styled Drawer Min: 7 1/2" W x 5 7/8" H (Stiles: 2 5/16" Rails: 1 1/2")

Doors less than 7 1/2" W will be a 3/4" thick solid wood flat slab with profiled edges.

Doors over 48" high will have two panels. Door premiums will be charged per each panel.

### ■ Glass Door and Mullion Styling: Available

### ■ Available on radius and Z door cabinets.

### EURO

	Plain	Raised	Styled
■ PRICE: Drawers	NC	x	\$40
■ PRICE: Doors	\$20		

## ARLINGTON

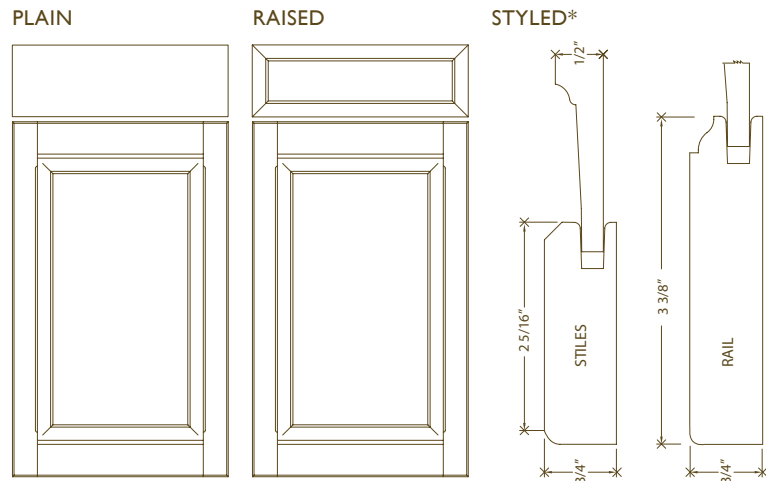

- **Features:**
  - Lip: L-149
  - Raise: no changes
  - Bead: no changes
- **Construction Features:**
  - Mortise & Tenon Joint
  - Center Panel: Raised, 5/8"
  - Thickness: 3/4"
  - Stiles: 2 5/16"
  - Rails: 3 3/8"
- **Sizes Constraints:**
  - Door Min.: 8" W x 10 1/8" H
  - Raised Drawer Min.: 3 1/4" W x 3 1/4" H
  - \* Styled Drawer Min.: 8" W x 8 13/16" H and styled drawers up to 10" high (Stiles: 2 5/16" Rails: 2 5/8")
  - Style Drawers 10 1/8" high and higher have 3 3/8" rails
  - Doors less than 8" wide will be a plain front unless specified as raised.
  - Doors over 48" high will have two panels. Door premiums will be charged per each panel.
- **Glass Door and Mullion Styling:** Available
- **Not available on radius and Z door cabinets.**

EURO	Plain	Raised	Styled
■ PRICE: Drawers	NC	\$22	\$94
■ PRICE: Doors	\$108		

## TURIN

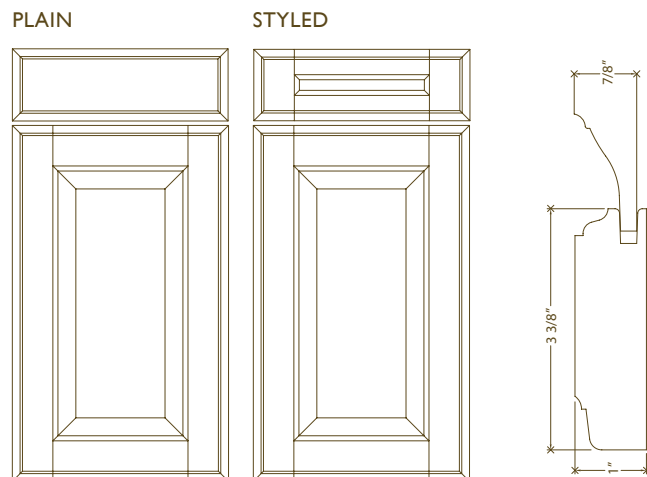

- **Features:**
  - Lip: no changes
  - Raise: no changes
  - Bead: no changes
- **Construction Features:**
  - Mortise & Tenon Joint
  - Center Panel: Raised, 7/8"
  - Thickness: 1"
  - Stiles: 3 3/8"
  - Rails: 3 3/8"
- **Size Constraints:**
  - Door Min: 10 3/8" W x 10 3/8" H
  - Styled Drawer Min: 7 3/8" W x 5 3/8" H (Stiles: 3 3/8" Rails: 2 1/4")
  - Doors less than minimum size will be a 1" thick plain front with profiled edges.
  - Doors over 48" high will have two panels. Door premiums will be charged per each panel.
- **Glass Door:** WGPW.
- **Not available on Radius or Z Door Cabinets**
- **Not available in Rustic wood species.**
- **Uses 95° thick door hinge.**

EURO	Plain	Raised	Styled
■ PRICE: Drawers	NC	x	\$92
■ PRICE: Doors	\$128		

## GENOA

PLAIN

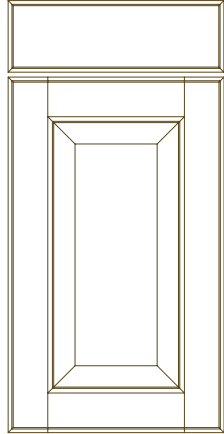

STYLED

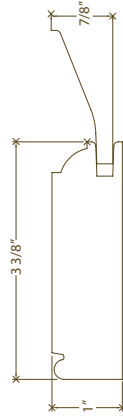
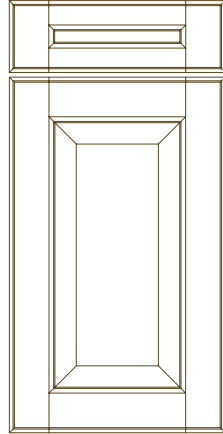

EURO	Plain	Raised	Styled
■ PRICE: Drawers	NC	x	\$92
■ PRICE: Doors	\$128		

### ■ Features:

Lip: no changes  
Raise: no changes  
Bead: no changes

### ■ Construction Features:

Mortise & Tenon Joint  
Center Panel: Raised, 7/8"  
Thickness: 1"  
Stiles: 3 3/8"  
Rails: 3 3/8"

### ■ Size Constraints:

Door Min: 10 3/8" W x 10 3/8" H  
Styled Drawer Min: 7 5/8" W x 5 3/8" H (Stiles: 3 3/8" Rails: 2 1/4")

Doors less than minimum size will be a 1" thick plain front with profiled edges.

Doors over 48" high will have two panels. Door premiums will be charged per each panel.

### ■ Glass Door: WGPW only.

### ■ Not available on radius and Z door cabinets.

### ■ Not available in Rustic woods.

### ■ Uses 95° thick door hinge.

## PROVINCIAL

PLAIN

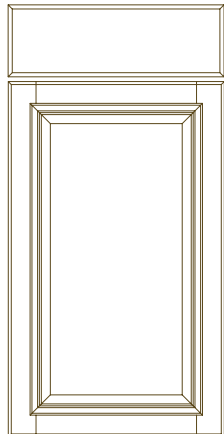

STYLED

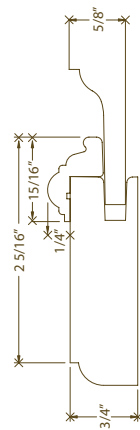
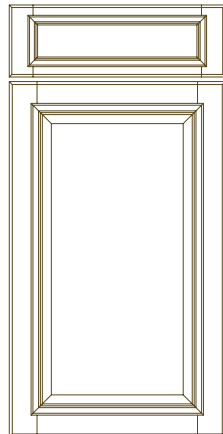

EURO	Plain	Raised	Styled
■ PRICE: Drawers	NC	x	\$86
■ PRICE: Doors	\$126		

### ■ Features:

Lip: PRS-2  
Raise: no changes  
Bead: no changes

### ■ Construction Features:

Mortise & Tenon Joint  
Center Panel: Raised, 5/8"  
Thickness: 3/4"  
Stiles: 2 5/16"  
Rails: 2 5/16"

### ■ Size Constraints:

Door Min: 6 3/4" W x 6 3/4" H  
Styled Drawer Min: 7 1/8" W x 4" H (Stiles: 2 5/16" Rails: 1 1/2")

Doors less than 6 3/4" wide will be a 3/4" thick solid wood flat slab with profiled edges.

Doors over 48" high will have two panels. Door premiums will be charged per each panel.

### ■ Glass Door: WGPW only.

### ■ Not available in radius or Z door cabinets.

## MILANO

### PLAIN

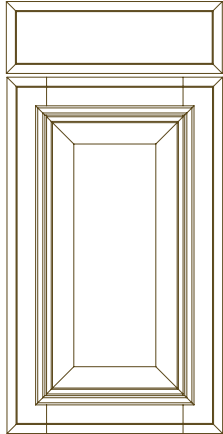

### STYLED

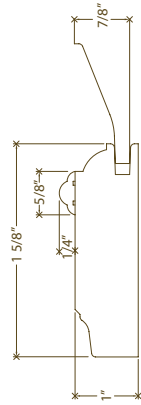
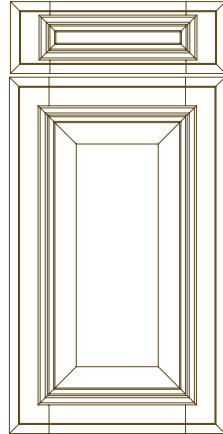

#### EURO

- PRICE: Drawers
- PRICE: Doors

#### Plain

NC  
\$204

#### Raised

x

#### Styled

\$118

#### ■ Features:

Lip: no changes  
Raise: no changes  
Bead: no changes

#### ■ Construction Features:

Mortise & Tenon Joint  
Center Panel: Raised, 7/8"  
Thickness: 1"  
Stiles: 3 3/8"  
Rails: 3 3/8"

#### ■ Size Constraints:

Door Min: 10 3/8" W x 10 3/8" H  
Styled Drawer Min: 7 5/8" W x 5 3/8" H (Stiles: 3 3/8" Rails: 2 1/4")

Doors less than minimum size will be a 1" thick plain front with profiled edges.

Doors over 48" high will have two panels. Door premiums will be charged per each panel.

#### ■ Wood Species: Red Oak, Maple, Cherry and Paint Grade.

#### ■ Additional Shapes: none

#### ■ Glass Door: WGPW only.

#### ■ Not available on radius and Z door cabinets.

#### ■ Uses 95° thick door hinge.

## VERSAILLES

### PLAIN

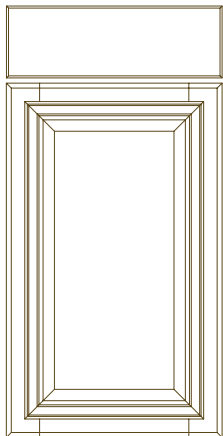

### RAISED

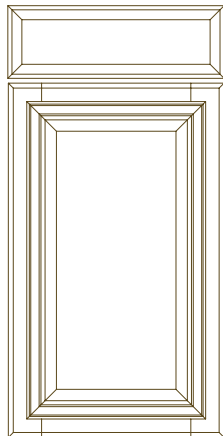

### STYLED

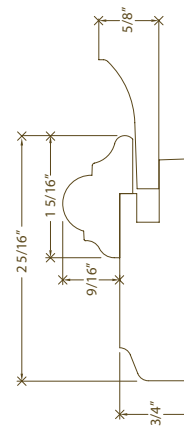
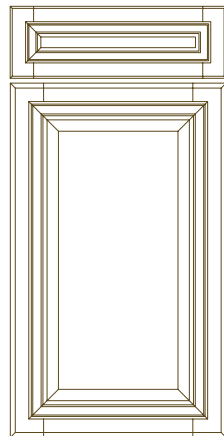

#### EURO

- PRICE: Drawers
- PRICE: Doors

#### Plain

NC  
\$154

#### Raised

\$22

#### Styled

\$132

#### ■ Features:

Lip: H-2  
Raise: no changes  
Bead: no changes

#### ■ Construction Features:

Mortise & Tenon Joint  
Center Panel: Raised, 3/4"  
Thickness: 3/4"  
Stiles: 2 5/16"  
Rails: 2 5/16"

#### ■ Size Constraints:

Door Min: 7 1/2" W x 7 1/2" H  
Styled Drawer Min: 7 1/8" W x 6 1/8" H. Stiles and rails may be reduced to accommodate drawer front size.

Doors less than 7 1/2" wide will be an applied moulding drawer front.

Doors over 48" high will have two panels. Door premiums will be charged per each panel.

#### ■ Glass Door and Mullion Styling: Available

#### ■ Not available on radius and Z door cabinets.

## ■ || SAVONA

### PLAIN

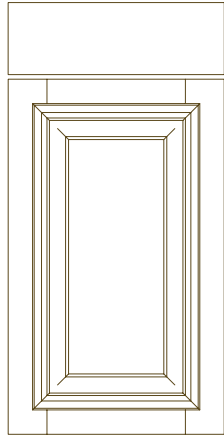

### STYLED

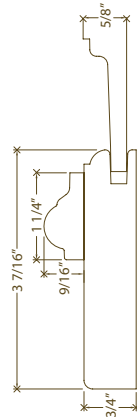
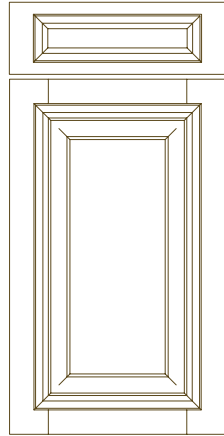

EURO	Plain	Raised	Styled
■ PRICE: Drawers	NC	x	\$118
■ PRICE: Doors	\$204		

#### ■ Features:

Lip: no changes  
Raise: no changes  
Bead: no changes

#### ■ Construction Features:

Mortise & Tenon Joint  
Center Panel: Raised, 5/8"  
Thickness: 3/4"  
Stiles: 3 7/16"  
Rails: 3 7/16"

#### ■ Size Constraints:

Door Min: 10 1/2" W x 10 1/2" H  
Styled Drawer Min: 3/4" thick plain front with applied moulding  
(Stiles: 3 3/8" Rails: 2 1/4")

Doors less than minimum size will be a 1" thick plain front with profiled edges.

Doors over 48" high will have two panels. Door premiums will be charged per each panel.

Doors over 26" wide and/or 48" high may be ordered with an additional horizontal rail or vertical stile for \$116.00. Must Specify.

#### ■ Glass Door and Mullion Styling: Available

#### ■ Not available in radius or Z door cabinets

#### ■ Not available in rustic woods.

## ■ || FRANKLIN

### PLAIN

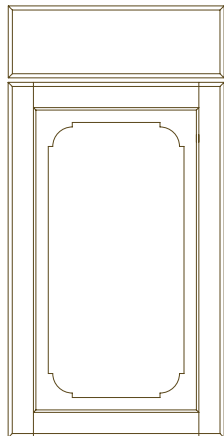

### RAISED

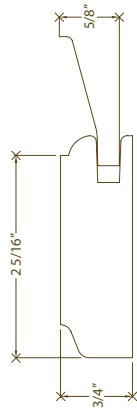
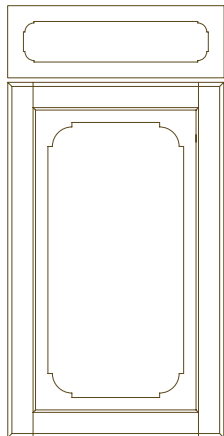

EURO	Plain	Raised	Styled
■ PRICE: Drawers	NC	\$136	x
■ PRICE: Doors	\$318		

#### ■ Features:

Lip: C-2  
Raise: regular  
Bead: no changes

#### ■ Construction Features:

Mortise & Tenon Joint  
Center Panel: Raised, 5/8"  
Thickness: 3/4"  
Stiles: 2 5/16"  
Rails: 2 5/16"

#### ■ Size Constraints:

Door Min: 11 7/8" W x 11 7/8" H

Doors less than 11 7/8" W will be a 3/4" thick solid wood flat slab with profiled edges.

Doors over 48" high will have two panels. Door premiums will be charged per each panel.

#### ■ Glass Door and Mullion Styling: Available

#### ■ Not available on radius and Z door cabinets.

## CAMBRIDGE

### PLAIN

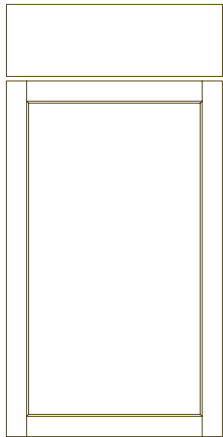

### STYLED

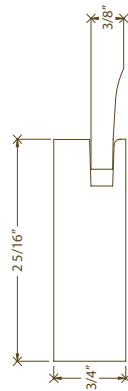
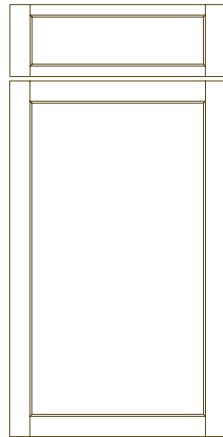

#### ■ Features:

Lip: Machine  
Raise: Machine  
Bead: Machine

#### ■ Construction Features:

Mortise & Tenon Joint  
Center Panel: Flat, 3/8"  
Thickness: 3/4"  
Stiles: 2 5/16"  
Rails: 2 5/16"

#### ■ Size Constraints:

Door Min: 7 1/2" W x 7 1/2" H  
Styled Drawer Min: 7 1/8" W x 3 7/8" H (Stiles: 2 5/16" Rails: 1 1/2" W)  
Doors less than 7 1/2" wide will be a 3/4" thick solid wood flat slab with profiled edges.  
Doors over 48" high will have two panels. Door premiums will be charged per each panel.

#### ■ Glass Door and Mullion Styling: Available

#### ■ Available on radius and Z door cabinets.

#### EURO

	Plain	Raised	Styled
■ PRICE: Drawers	NC	x	\$40
■ PRICE: Doors	\$15		

## RICHMOND

### PLAIN

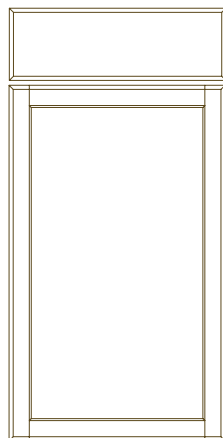

### STYLED

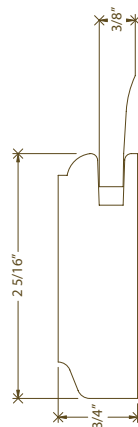
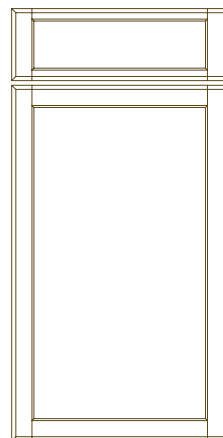

#### ■ Features:

Lip: C-2  
Raise:  
Bead: Regular

#### ■ Construction Features:

Mortise & Tenon Joint  
Center Panel: Reverse Flat, 3/8"  
Thickness: 3/4"  
Stiles: 2 5/16"  
Rails: 2 5/16"

#### ■ Size Constraints:

Door Min: 7 1/2" W x 7 1/2" H  
Styled Drawer Min: 7 1/8" W x 3 7/8" H (Stiles: 2 5/16", Rails: 1 1/2" W)  
Doors less than 7 1/2" wide will be a 3/4" thick solid wood flat slab with profiled edges.  
Doors over 48" high will have two panels. Door premiums will be charged per each panel.

#### ■ Glass Door and Mullion Styling: Available

#### ■ Not available on radius and Z door cabinets.

#### EURO

	Plain	Raised	Styled
■ PRICE: Drawers	NC	x	\$40
■ PRICE: Doors	\$15		



## ■ CAPE COD

PLAIN

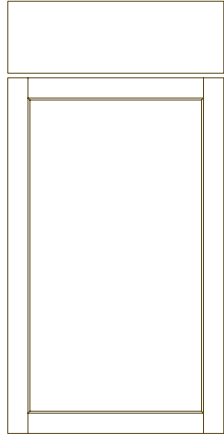

STYLED

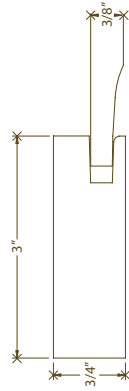
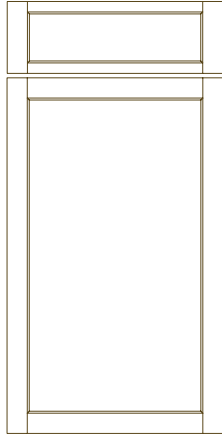

### ■ Features:

Lip: Machine  
Raise: Machine  
Bead: Machine

### ■ Construction Features:

Mortise & Tenon Joint  
Center Panel: Flat, 3/4"  
Thickness: 3/8"  
Stiles: 3"  
Rails: 3"

### ■ Size Constraints:

Door Min: 7 1/2" W x 7 1/2" H

Styled Drawer Min: 7 1/8" W x 3 7/8" H (Stiles: 3" Rails: 1 1/2" W)

Doors less than 7 1/2" wide will be a 3/4" thick solid wood flat slab with profiled edges.

Doors over 48" high will have two panels. Door premiums will be charged per each panel.

### ■ Glass Door and Mullion Styling: Available

### ■ Available on radius and Z door cabinets.

### EURO

■ PRICE: Drawers

### Plain

NC

### Raised

x

### Styled

\$40

■ PRICE: Doors

\$32

## ■ NANTUCKET

PLAIN

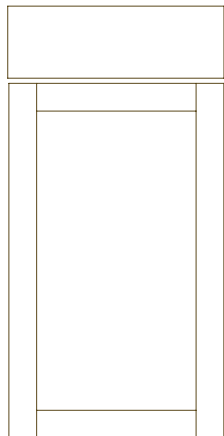

STYLED

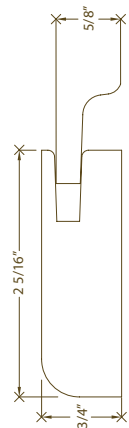
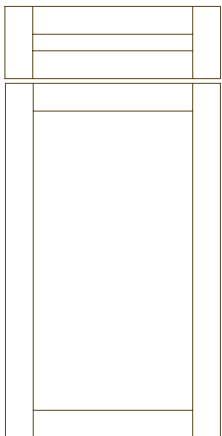

### ■ Features:

Lip: no changes  
Raise: no changes  
Bead: no changes

### ■ Construction Features:

Mortise & Tenon Frame  
Center Panel: Reverse Raised, 5/8"  
Thickness: 3/4"  
Stiles: 2 5/16"  
Rails: 2 5/16"

### ■ Size Constraints:

Door Min: 7 1/2" W x 7 1/2" H

Styled Drawer Min: 7 1/2" W x 5 7/8" H

(Stiles: 2 5/16" Rails: 1 1/2" W)

Doors over 48" high will have two panels. Door premiums will be charged per each panel.

Doors less than 7 1/2" wide will be plain wood slabs with profiled edges.

### ■ Glass Door and Mullion Styling: Available

### ■ Not available on radius and Z door cabinets.

### EURO

■ PRICE: Drawers

### Plain

NC

### Raised

x

### Styled

\$40

■ PRICE: Doors

\$20

## CHESAPEAKE

PLAIN

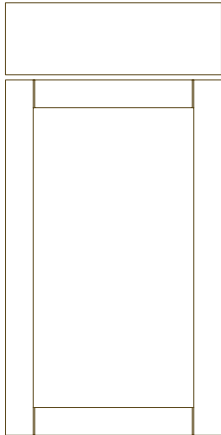

STYLED

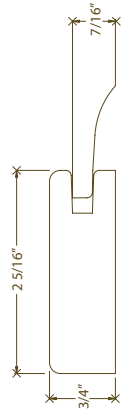
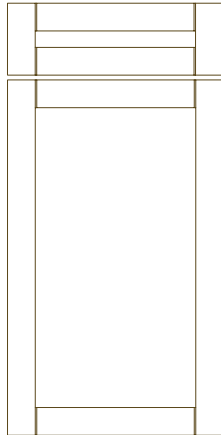

EURO	Plain	Raised	Styled
■ PRICE: Drawers	NC	x	\$72
■ PRICE: Doors	\$72		

### Features:

Lip: L-149  
 Raise: no changes  
 Bead: no changes

### Construction Features:

Mortise & Tenon Frame  
 Center Panel: Reverse Raised, 1/2"  
 Thickness: 3/4"  
 Stiles:  
 Rails:

### Size Constraints:

Door Min: 7" W x 7" H  
 Styled Drawer Min: 6" W x 5 1/2" H

Door less than 7" wide will be a 3/4" solid wood flat slab with matching edge profile.

Doors over 48" high will have two panels. Door premiums will be charged per each panel.

### Glass Door and Mullion Styling: Available

### Available on radius and Z door cabinets.

## PLYMOUTH

PLAIN

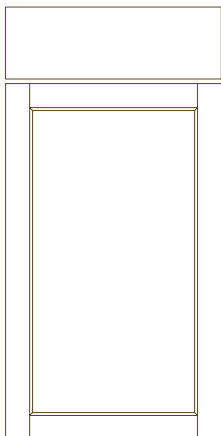

STYLED

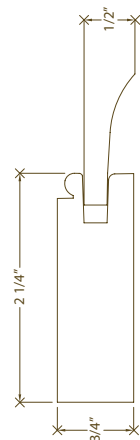
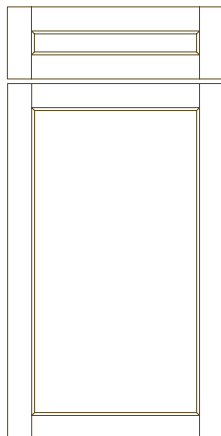

EURO	Plain	Raised	Styled
■ PRICE: Drawers	NC	x	\$72
■ PRICE: Doors	\$72		

### Features:

Lip: Machine  
 Raise:  
 Bead:

### Construction Features:

Mortise & Tenon  
 Center Panel: Flat, 1/2"  
 Thickness: 3/4"  
 Stiles: 2 1/4"  
 Rails: 2 1/4"

### Size Constraints:

Door Min: 6 7/8" W x 6 7/8" H  
 Styled Drawer Min: 5 7/8" W x 5 3/8" H

Doors less than 6 7/8" wide will be a 3/4" thick solid wood flat slab with profiled edges.

Single panel doors over 26" wide and/or 48" high are not guaranteed against warpage.

Doors over 26" wide and/or 48" high may be ordered with an additional horizontal rail or vertical stile for \$116.00. Must specify.

### Glass Door: WGPW only.

### Not available on radius, Z door cabinets or Rustic woods.

## ■ || PITTSFIELD

### PLAIN

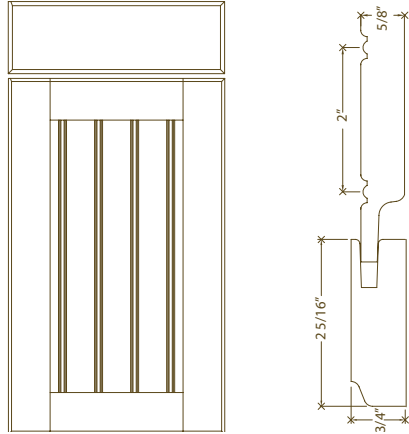

EURO	Plain	Raised	Styled
■ PRICE: Drawers	NC	x	x
■ PRICE: Doors	\$72		

#### ■ Features:

Lip: C-2  
Raise: no changes  
Bead: no changes

#### ■ Construction Features:

Mortise & Tenon Frame  
Center Panel: Raised, 5/8"  
Thickness:  
Stiles:  
Rails:

#### ■ Size Constraints:

Door Min: 7 1/2" W x 7 1/2" H

Doors over 48" high will have two panels. Door premiums will be charged per each panel.

#### ■ Glass Door and Mullion Styling: Available

#### ■ Not available on radius, Z door cabinets or Rustic woods.

## ■ || KÖLN

### PLAIN

### STYLED- 3psc

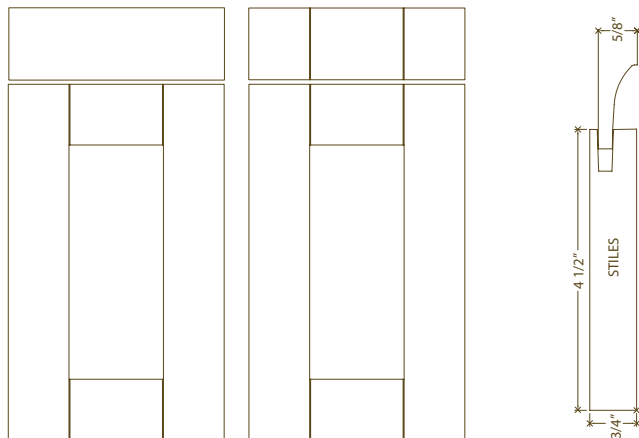

EURO	Plain	Raised	Styled
■ PRICE: Drawers	NC	x	\$108
PRICE: Doors	\$108		

#### ■ Features:

Lip: no change  
Raise: no change  
Bead: no change

#### ■ Construction Features:

Mortise & Tenon Frame  
Center Panel: Reverse Raised, 5/8"  
Thickness: 3/4"  
Stiles: 4 1/2"  
Rails: 4 1/2"

#### ■ Size Constraints:

Cabinet Min: 15" W recommended.

Door Min: 11 1/8" W x 11 1/8" H with reduced stiles and/or rails

Styled Drawer Min: 11 1/8" W x 11 1/8" H

Doors over 48" high will have two panels. Door premiums will be charged per each panel.

#### ■ Glass Door: WGPW only.

#### ■ Not available on radius and Z door cabinets.

## BERMEN

### PLAIN

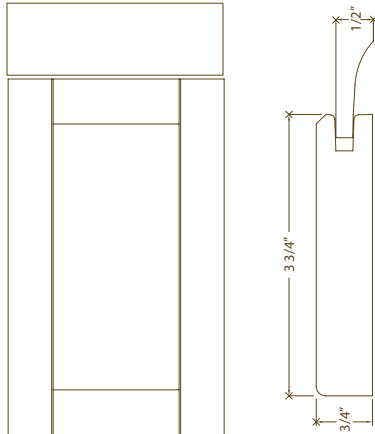

#### EURO

#### ■ PRICE: Drawers

#### ■ PRICE: Doors

#### Plain

NC

\$138

#### Raised

x

#### Styled

\$138

#### ■ Features:

Lip: no changes  
Raise: no changes  
Bead: no changes

#### ■ Construction Features:

Mortise and Tenon Frame  
Center Panel: Reverse Raised, 1/2"  
Thickness: 3/4"  
Stiles: 3 3/4"  
Rails: 3 3/4"

#### ■ Size Constraints:

Cabinet Min: 15" W recommended  
Door Min: 10 1/8" W x 10 1/8" H  
Styled Drawer Min: 10 1/8" W x 10 1/8" H

Doors over 48" high will have two panels. Door premiums will be charged per each panel plus \$30 for each additional horizontal rail or vertical stile.

#### ■ Glass Door: WGPW only.

#### ■ Not available on radius and Z door cabinets.

## VERMONT

### PLAIN

### STYLED

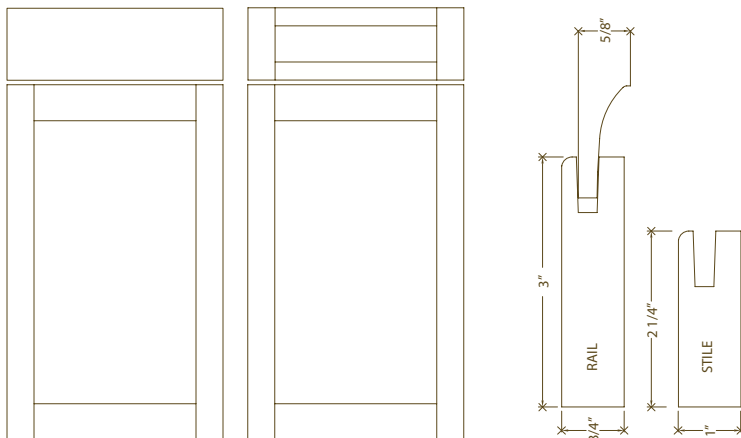

#### ■ EURO

#### ■ PRICE: Drawers

#### PRICE: Doors

#### Plain

NC

\$138

#### Raised

x

#### Styled

\$138

#### ■ Features:

Lip: no changes  
Raise: no changes  
Bead: no changes

#### ■ Construction Features:

Mortise & Tenon Frame  
Center Panel: Reverse Raised, 1/2"  
Thickness: 3/4"  
Stiles: 2 1/4 x 1" stiles  
Rails: 3" x 3/4"

#### ■ Size Constraints:

Cabinet Min: 15" W recommended  
Door Min: 10 1/8" W x 10 1/8" H  
Styled Drawer Min: 10 1/8" W x 10 1/8" W

Doors over 48" high will have two panels. Door premiums will be charged per each panel plus \$30 for each additional horizontal rail or vertical stile.

#### ■ Glass Door: WGPW only.

#### ■ Not available on radius and Z door cabinets.

## ■ BIRMINGHAM

### PLAIN

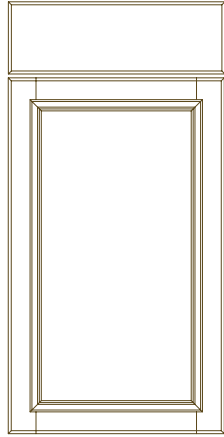

### STYLED

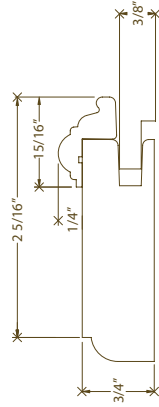
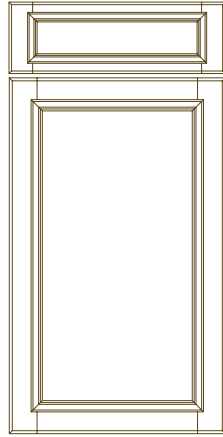

#### ■ Features:

Lip: PRS-2  
Raise: no changes  
Bead: no changes

#### ■ Construction Features:

Mortise & Tenon Joint  
Center Panel: Flat, 3/8"  
Thickness: 3/4"  
Stiles: 2 5/16"  
Rails: 2 5/16"

#### ■ Size Constraints:

Door Min: 6 3/4" W x 6 3/4" H  
Styled Drawer Min: 7 1/8" W x 4" H (Stiles: 2 5/16" Rails: 1 1/2")

Doors less than 6 3/4" wide will be a 3/4" thick solid wood plain with profiled edges.

Doors over 48" high will have two panels. Door premiums will be charged per each panel.

#### ■ Glass Door: Available

#### ■ Not Available in Radius or Z door cabinets.

#### EURO

	Plain	Raised	Styled
■ PRICE: Drawers	NC	x	\$86
■ PRICE: Doors	\$126		

## ■ DAUPHIN

### PLAIN

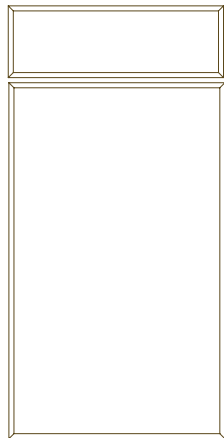

### STYLED

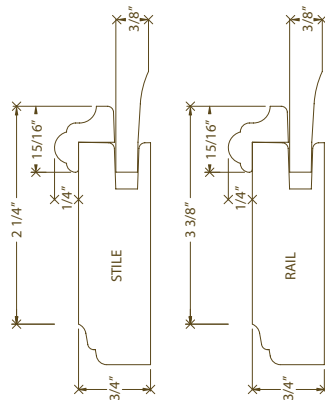
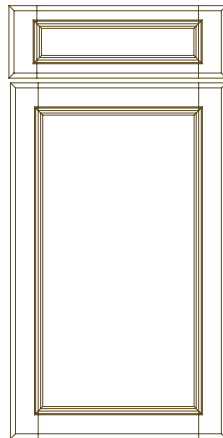

#### ■ Features:

Lip: PRS-2  
Raise: no changes  
Bead: no changes

#### ■ Construction Features:

Mortise & Tenon Joint  
Center Panel: Flat, 3/8"  
Thickness: 3/4"  
Stiles: 2 5/16"  
Rails: 3 3/8"

#### ■ Size Constraints:

Door Min: 6 3/4" W x 6 3/4" H  
Styled Drawer Min: 7 1/8" W x 4" H (Stiles: 2 5/16" Rails: 1 1/2")

Doors less than 6 3/4" wide will be a 3/4" thick solid wood plain with profiled edges.

Doors over 48" high will have two panels. Door premiums will be charged per each panel.

#### ■ Glass Door: Available

#### ■ Not available on radius, Z door cabinets or Rustic woods.

#### EURO

	Plain	Raised	Styled
■ PRICE: Drawers	NC	x	\$86
■ PRICE: Doors	\$126		

## SONOMA

### STYLED

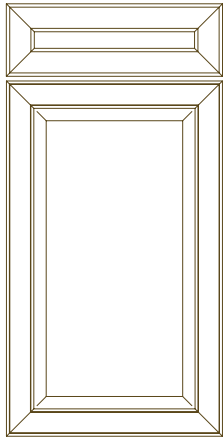

EURO	Plain	Raised	Styled
■ PRICE: Drawers	x	x	\$58
■ PRICE: Doors	\$58		

#### ■ Features:

Lip: Unique  
Raise: Unique  
Bead: Unique

#### ■ Construction Features:

Mitre Joint  
Center Panel: Raised, 5/8"  
Thickness: 3/4"  
Stiles: 2 5/16"  
Rails: 2 5/16"

#### ■ Size Constraints:

Door Min: 7 1/2" W x 7 1/2" H  
Styled Drawer Min: 5 1/2" W x 5 1/2" H

Doors less than 7 1/2" wide will be a 3/4" thick solidwood flat slab with profiled edges.

Single panel doors over 26" wide and/or 48" high are not guaranteed against warpage.

Doors over 26" wide and/or 48" high may be ordered with an additional horizontal rail or vertical stile for \$116.00. Must Specify.

#### ■ Glass Door: WGPW only.

#### ■ Not available on radius, Z door cabinets or Rustic woods.

## ESTATE

### STYLED

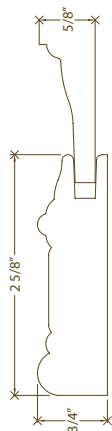
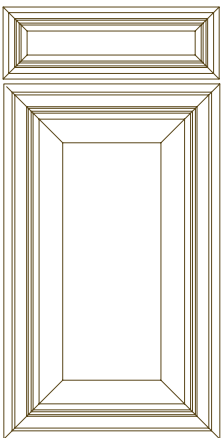

EURO	Plain	Raised	Styled
■ PRICE: Drawers	NC	x	\$58
■ PRICE: Doors	\$58		

#### ■ Features:

Lip: Unique  
Raise: Unique  
Bead: Unique

#### ■ Construction Features:

Mitre Joint  
Center Panel: Raised, 5/8"  
Thickness: 3/4"  
Stiles: 2 5/8"  
Rails: 2 5/8"

#### ■ Size Constraints:

Door Min: 7 1/2" W x 7 1/2" H  
Styled Drawer Min: 5 1/2" W x 5 1/2" H - 2" framing - Recessed Center Panel

Doors less than 7 1/2" wide will be a 3/4" thick solid wood flat slab with profiled edges.

Single panel doors over 26" wide and/or 48" high are not guaranteed against warpage.

Doors over 26" wide and/or 48" high may be ordered with an additional horizontal rail or vertical stile for \$116.00. Must Specify.

#### ■ Glass Door: WGPW only.

#### ■ Not available on radius, Z door cabinets or Rustic woods.

## ■ AUGUSTA

### STYLED

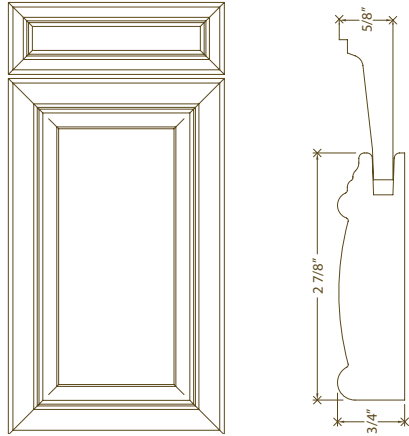

EURO	Plain	Raised	Styled
■ PRICE: Drawers	x	x	\$72
■ PRICE: Doors	\$86		

#### ■ Features:

Lip: Unique  
Raise: Unique  
Bead: Unique

#### ■ Construction Features:

Mitre Frame  
Center Panel: Raised, 5/8"  
Thickness: 3/4"  
Stiles: 2 7/8"  
Rails: 2 7/8"

#### ■ Size Constraints:

Door Min: 8 5/8" W x 8 5/8" H  
Styled Drawer Min: 4 7/8" W x 4 7/8" H, 2" framing- Recessed Center panel.

Single panel doors over 26" wide and/or 48" high are not guaranteed against warpage.

Doors over 26" wide and/or 48" high may be ordered with an additional horizontal rail or vertical stile for \$116.00. Must Specify.

#### ■ Glass Door: WGPW only.

#### ■ Not available on radius, Z door cabinets or Rustic woods.

## ■ AHERTON

### PLAIN

### RAISED

### STYLED

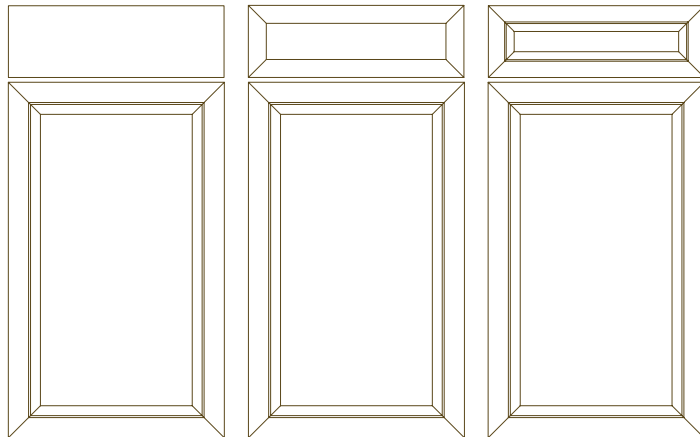

EURO	Plain	Raised	Styled
■ PRICE: Drawers	NC	\$22	\$46
■ PRICE: Doors	\$138		

#### ■ Features:

Lip: Unique  
Raise: Unique  
Bead: Unique

#### ■ Construction Features:

Mitre Joint  
Center Panel: Raised, 3/4"  
Thickness: 2 3/8"  
Stiles: 2 3/4"  
Rails: 2 3/4"

#### ■ Size Constraints:

Door Min: 7 1/2" W x 7 1/2" H  
Styled Drawer Min: 7 1/2" W x 7 1/2" H

Doors less than 7 1/2" wide will be a 3/4" thick solid wood flat slab with profiled edges.

Single panel doors over 26" wide and/or 48" high are not guaranteed against warpage.

Doors over 26" wide and/or 48" high may be ordered with an additional horizontal rail or vertical stile for \$116.00. Must Specify.

#### ■ Glass Door: WGPW only.

#### ■ Not available on radius, Z door cabinets or Rustic woods.

## ■ || SAXONY

### PLAIN

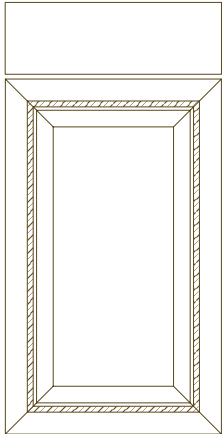

### STYLED

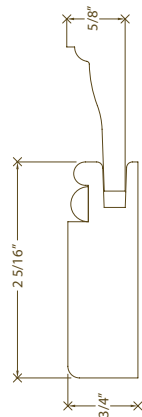
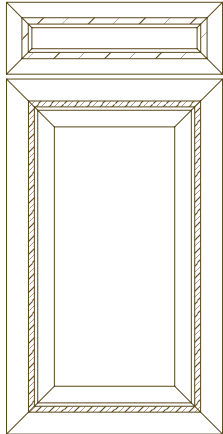

EURO	Plain	Raised	Styled
■ PRICE: Drawers	NC	x	\$68
■ PRICE: Doors	\$148		

#### ■ Features:

Lip: Unique  
Raise: Unique  
Bead: Unique

#### ■ Construction Features:

Mitre Joint  
Center Panel: Raised, 3/8"  
Thickness: 3/4"  
Stiles: 2 5/16"  
Rails: 2 5/16"

#### ■ Size Constraints:

Door Min: 7 1/2" W x 7 1/2" H  
Styled Drawer Min: 4 3/8" W x 4 3/8" H, Framing: 1 3/4"

Doors less than 7 1/2" wide will be a 3/4" thick solid wood flat slab with profiled edges.

Single panel doors over 26" wide and/or 48" high are not guaranteed against warpage.

Doors over 26" wide and/or 48" high may be ordered with an additional horizontal rail or vertical stile for \$116.00. Must Specify.

#### ■ Glass Door: WGPW only.

#### ■ Not available on radius, Z door cabinets or Rustic woods.

## ■ || SEXTANT

### STYLED

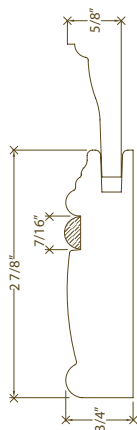
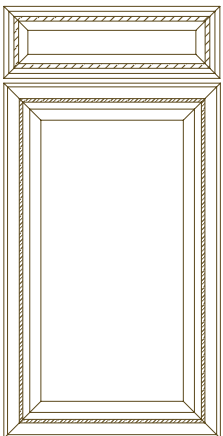

EURO	Plain	Raised	Styled
■ PRICE: Drawers	x	x	\$72
■ PRICE: Doors	\$152		

#### ■ Features:

Lip: Unique  
Raise: Unique  
Bead: Unique

#### ■ Construction Features:

Mitre Joint  
Center Panel: Raised, 5/8"  
Thickness: 3/4"  
Stiles: 2 7/8"  
Rails: 2 7/8"  
Inlay: 3/8"

#### ■ Size Constraints:

Door Min: 8 5/8" W x 8 5/8" H  
Styled Drawer Min: 4 7/8" W x 4 7/8" H, 2" framing

Single panel doors over 26" wide and/or 48" high are not guaranteed against warpage.

Doors over 26" wide and/or 48" high may be ordered with an additional horizontal rail or vertical stile for \$116.00. Must Specify.

#### ■ Glass Door: WGPW only.

#### ■ Not available on radius, Z door cabinets or Rustic woods.



## ■ || VALLEJO

### STYLED

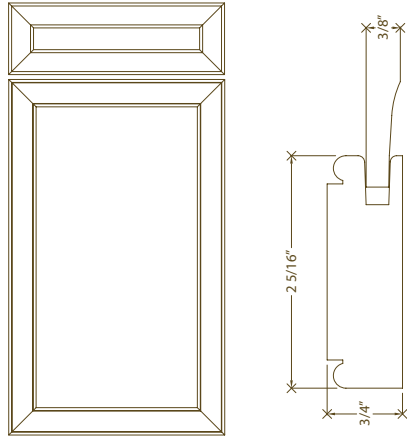

EURO	Plain	Raised	Styled
■ PRICE: Drawers	x	x	\$58
■ PRICE: Doors	\$58		

#### ■ Features:

Lip: Unique  
Raise: Unique  
Bead: Unique

#### ■ Construction Features:

Mitre Joint  
Center Panel: Raised, 3/8"  
Thickness: 3/4"  
Stiles: 2 5/16"  
Rails: 2 5/16"

#### ■ Size Constraints:

Door Min: 7 1/2" W x 7 1/2" H  
Styled Drawer Min: 5 1/2" W x 5 1/2" H

Doors less than 7 1/2" wide will be a 3/4" thick solid wood flat slab with profiled edges.

Single panel doors over 26" wide and/or 48" high are not guaranteed against warpage.

Doors over 26" wide and/or 48" high may be ordered with an additional horizontal rail or vertical stile for \$116.00. Must Specify.

#### ■ Glass Door: WGPW only.

#### ■ Not available on radius, Z door cabinets or Rustic woods.

## ■ || MONTICELLO

### STYLED

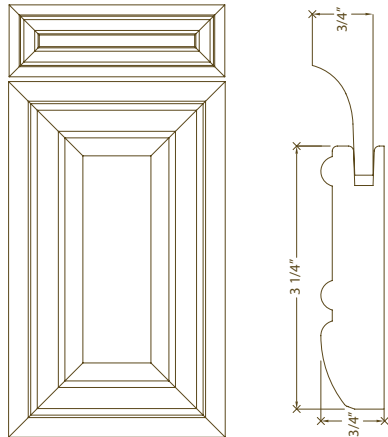

EURO	Plain	Raised	Styled
■ PRICE: Drawers	x	x	\$86
■ PRICE: Doors	\$214		

#### ■ Features:

Lip: Unique  
Raise: Unique  
Bead: Unique

#### ■ Construction Features:

Mitre Joint  
Center Panel: Raised, 3/4"  
Thickness: 3/4"  
Stiles: 3 1/4"  
Rails: 3 1/4"

#### ■ Size Constraints:

Door Min: 10" W x 10" H  
Styled Drawer Min: 7 3/4" H and under  
Min. 4 9/16" W x 4 7/16" H = 1 7/8" framing  
7 13/16" H & over  
Min 10" W x 7 13/16" H = 3 1/4" framing

Doors and drawers less than 10" wide or 10" high, respectively, will have a flat center panel.

Single panel doors over 26" wide and/or 48" high are not guaranteed against warpage.

Doors over 26" wide and/or 48" high may be ordered with an additional horizontal rail or vertical stile for \$116.00. Must Specify

#### ■ Glass Door: WGPW only.

#### ■ Not available on radius, Z door cabinets or Rustic woods.

## ROXBURY

PLAIN

STYLED

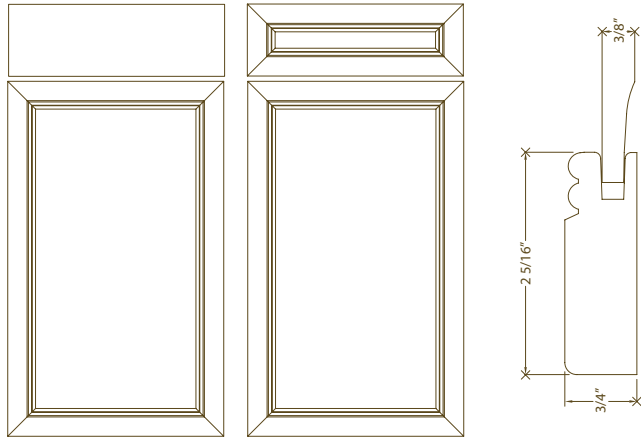

EURO

Plain

Raised

Styled

■ PRICE: Drawers

NC

x

\$58

■ PRICE: Doors

\$58

■ **Features:**

Lip: Unique  
Raise: Unique  
Bead: Unique

■ **Construction Features:**

Mitre Joint  
Center Panel: Raised, 3/8"  
Thickness: 3/4"  
Stiles: 2 5/16"  
Rails: 2 5/16"

■ **Size Constraints:**

Door Min: 7 1/2" W x 7 1/2" H  
Styled Drawer Min: 5 1/2" W x 5 1/2" H

Doors less than 7 1/2" wide will be a 3/4" thick solid wood flat slab with profiled edges.

Single panel doors over 26" wide and/or 48" high are not guaranteed against warpage.

Doors over 26" wide and/or 48" high may be ordered with an additional horizontal rail or vertical stile for \$116.00. Must Specify.

■ **Glass Door: WGPW only.**

■ **Not available on radius, Z door cabinets or Rustic woods.**

## RICHLAND

PLAIN

STYLED

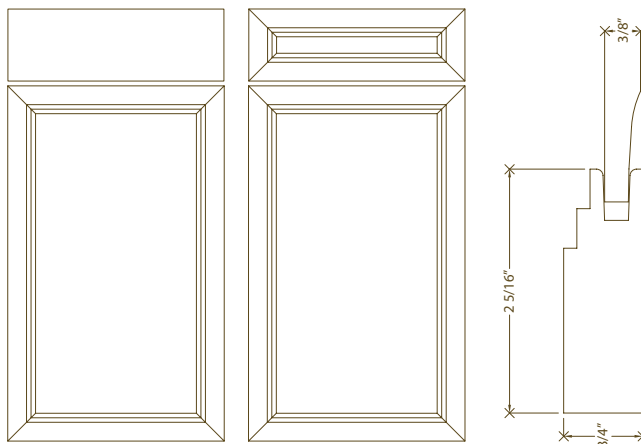

EURO

Plain

Raised

Styled

■ PRICE: Drawers

NC

x

\$58

■ PRICE: Doors

\$58

■ **Features:**

Lip: Unique  
Raise: Unique  
Bead: Unique

■ **Construction Features:**

Mitre Joint  
Center Panel: Raised, 3/8"  
Thickness: 3/4"  
Stiles: 2 5/16"  
Rails: 2 5/16"

■ **Size Constraints:**

Door Min: 6 3/4" W x 6 3/4" H  
Styled Drawer Min: 5 1/2" W x 5 1/2" H

Doors less than 6 3/4" wide will be a 3/4" thick solid wood flat slab with profiled edges.

Single panel doors over 26" wide and/or 48" high are not guaranteed against warpage.

Doors over 26" wide and/or 48" high may be ordered with an additional horizontal rail or vertical stile for \$116.00. Must Specify.

■ **Glass Door: WGPW only.**

■ **Not available on radius, Z door cabinets or Rustic woods.**

## ■ EUROPEAN

### PLAIN

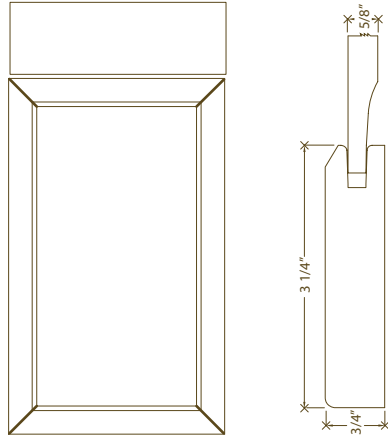

<b>EURO</b>	<i>Plain</i>	<i>Raised</i>	<i>Styled</i>
■ <b>PRICE: Drawers</b>	NC	x	x
■ <b>PRICE: Doors</b>	\$138		

#### ■ **Features:**

*Lip: Unique*  
*Raise: Unique*  
*Bead: Unique*

#### ■ **Construction Features:**

*Mitre Joint*  
*Center Panel: Raised, 3/8"*  
*Thickness: 3/4"*  
*Stiles: 3 1/4"*  
*Rails: 3 1/4"*

#### ■ **Size Constraints:**

*Door Min: 6 3/4" W x 6 3/4" H*

*Doors less than 6 3/4" wide will be a 3/4" thick solid wood flat slab with profiled edges.*

*Single panel doors over 26" wide and/or 48" high are not guaranteed against warpage.*

*Doors over 26" wide and/or 48" high may be ordered with an additional horizontal rail or vertical stile for \$116.00. Must Specify.*

#### ■ **Glass Door: WGPW only.**

#### ■ **Not available on radius, Z door cabinets or Rustic woods.**

## ■ VENICE

### PLAIN

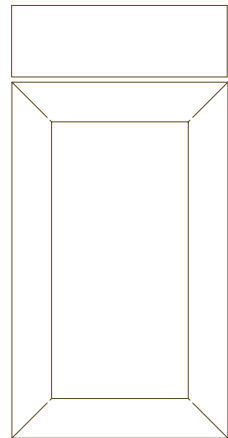

### STYLED

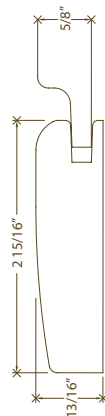
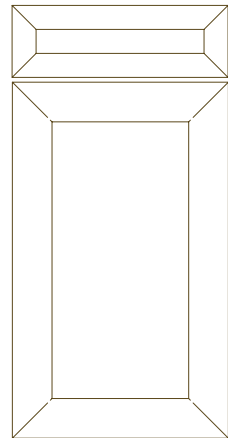

<b>EURO</b>	<i>Plain</i>	<i>Raised</i>	<i>Styled</i>
■ <b>PRICE: Drawers</b>	NC	x	\$72
■ <b>PRICE: Doors</b>	\$138		

#### ■ **Features:**

*Lip: Unique*  
*Raise: Unique*  
*Bead: Unique*

#### ■ **Construction Features:**

*Mitre Joint*  
*Center Panel: Raised, 5/8"*  
*Thickness: 3/4"*  
*Stiles: 2 7/8"*  
*Rails: 2 7/8"*

#### ■ **Size Constraints:**

*Door Min: 7 1/2" W x 7 1/2" H*

*Doors less than 7 1/2" wide will be a 3/4" thick solid wood flat slab with profiled edges.*

*Single panel doors over 26" wide and/or 48" high are not guaranteed against warpage.*

*Doors over 26" wide and/or 48" high may be ordered with an additional horizontal rail or vertical stile for \$116.00. Must Specify.*

#### ■ **Glass Door: WGPW only.**

#### ■ **Not available in radius or Z door cabinets**

#### ■ **Not available in Rustic wood specie.**

## ■ || POTTER

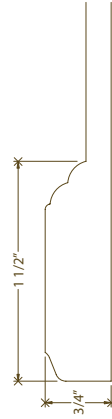
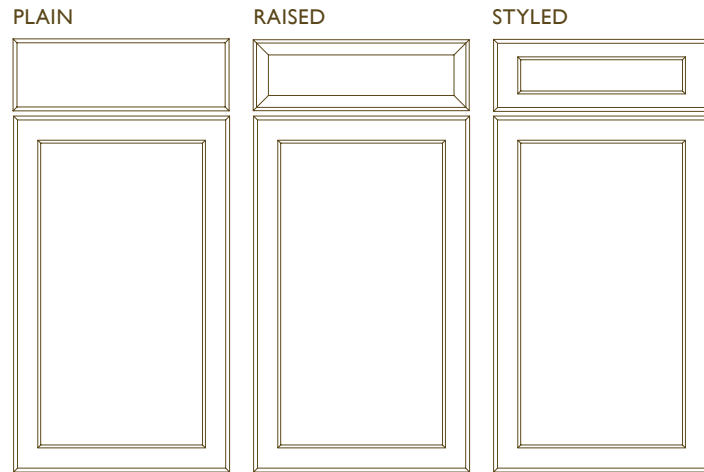

### ■ Door Features:

- Painted finishes only.
- Doors feature one piece 3/4" MDF recessed panel style construction.
- 3/4" x 2 1/4" door stiles and rails.
- Minimum door size - 7 1/2" wide x 7 1/2" high.
- Maximum door size - 24" wide by 48" high.
- Doors less than 7 1/2" wide will be a 3/4" thick solid MDF flat slab with profiled edges.
- Doors over 48" high will have one panel only.
- Maximum door width is 42".
- Maximum door height is 63".

### ■ Glass Door and Mullian available.

#### EURO

#### ■ PRICE: Drawers

#### Plain

NC

#### Raised

NC

#### Styled

NC

#### ■ PRICE: Doors

NC

## ■ || CAMBRIA - MDF

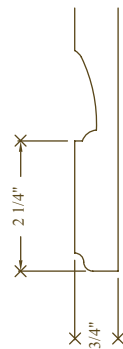
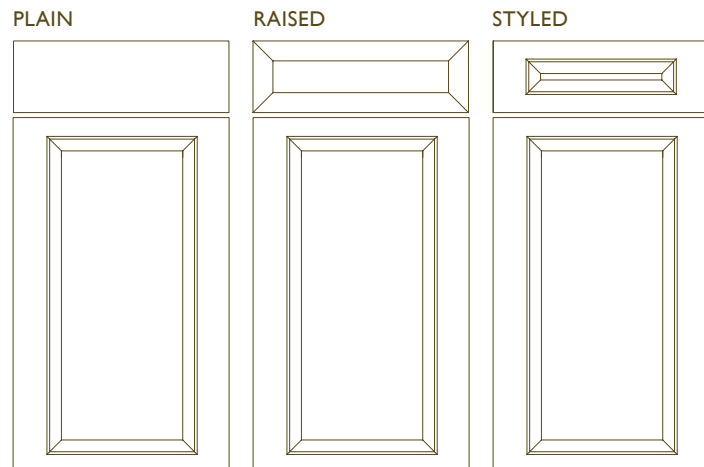

### ■ Door Features:

- Painted finishes only.
- Doors feature one piece 3/4" MDF raised panel style construction.
- 3/4" x 2 1/4" door stiles and rails.
- Minimum door size - 7 1/2" wide x 7 1/2" high.
- Maximum door size - 24" wide by 48" high.
- Doors less than 7 1/2" wide will be a 3/4" thick solid MDF flat slab with profiled edges.
- Doors over 48" high will have two center panels only.
- Maximum door width is 42".
- Maximum door height is 63".

### ■ Glass Door and Mullian available.

#### EURO

#### ■ PRICE: Drawers

#### Plain

NC

#### Raised

NC

#### Styled

NC

#### ■ PRICE: Doors

NC

## ■ || CAMBRIA ARCH

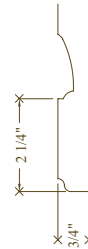
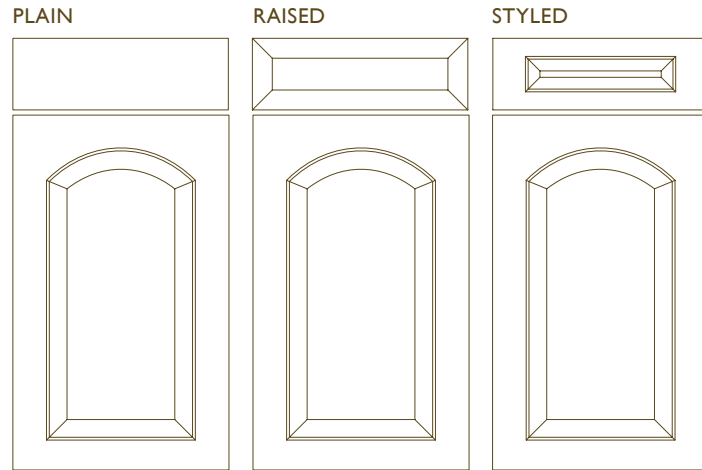

EURO	Plain	Raised	Styled
■ PRICE: Drawers	NC	NC	NC
■ PRICE: Doors	NC		

### ■ Door Features:

- Painted finishes only.
- Doors feature one piece 3/4" MDF raised panel style construction.
- 3/4" x 2 1/4" door stiles and rails.
- Minimum door size - 7 1/2" wide x 7 1/2" high.
- Maximum door size - 24" wide by 48" high.
- Doors less than 7 1/2" wide will be a 3/4" thick solid MDF flat slab with profiled edges.
- Doors over 48" high will have two center panels only.
- Maximum door width is 42".
- Maximum door height is 63".

### ■ Glass Door: WGPL only.

## ■ || GLENMARA - MDF

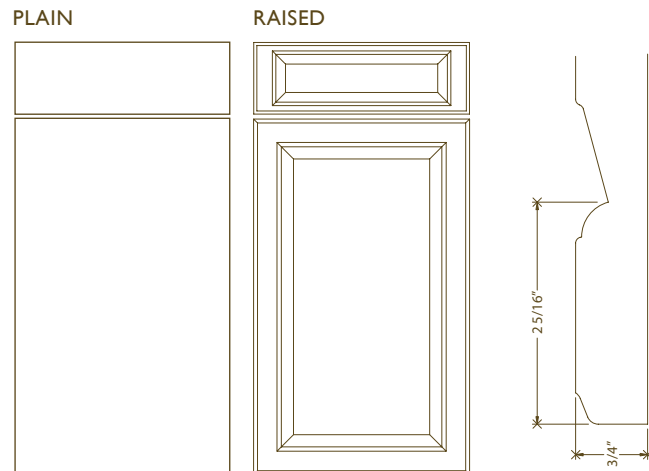

EURO	Plain	Raised	Styled
■ PRICE: Drawers	NC	NC	x
■ PRICE: Doors	NC		

### ■ Door Features:

- Painted finishes only.
- Doors feature one piece 3/4" MDF raised panel style construction.
- 3/4" x 2 1/4" door stiles and rails.
- Minimum door size - 7 1/2" wide x 7 1/2" high.
- Maximum door size - 24" wide by 48" high.
- Doors less than 7 1/2" wide will be a 3/4" thick solid MDF flat slab with profiled edges.
- Doors over 48" high will have one panel only.
- Maximum door width is 42".
- Maximum door height is 63".

### ■ Glass Door: WGPL only.

## WALL STREET

### PLAIN

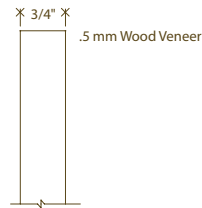
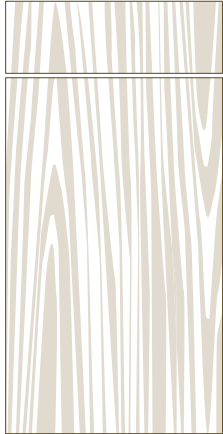

EURO	Plain	Raised	Styled
■ PRICE: Drawers	\$28	x	x
■ PRICE: Doors	\$28		

#### ■ Door Features:

- Euro - Red Oak, Maple, Red Birch, and Cherry.
- Not available in Painted Finishes.
- 3/4" veneer door. Furniture grade medium density fiberboard core.
- Maximum door size - 25" wide by 48" high.
- Doors and drawers in bases and tall cabinets are grain matched vertically to assure grain continuity. Variations in grain and tone may occur.
- Note: We will not replace any door for color or grain match problems.
- Radius and "Z" doors available.
- We recommend premium veneer selection on this door style (excluding Red Birch).

#### ■ Glass Door: WGPW only.

## WESTCHESTER

### STYLED

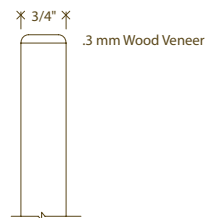
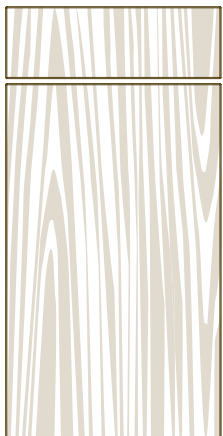

EURO	Plain	Raised	Styled
■ PRICE: Drawers	x	x	\$72
■ PRICE: Doors	\$72		

#### ■ Door Features:

- Euro - Red Oak, Maple, Red Birch, and Cherry.
- Not available in Painted Finishes.
- 3/4" veneered door with 3mm wood edging.
- Maximum door size - 25" wide by 48" high.
- 3mm edge has 1/8" radius on all exterior edges.
- Edge available in Oak, Maple, Cherry, Mahogany and Walnut made of laminated wood veneer - not solid wood.
- We recommend premium veneer on this door style (excluding Red Birch).
- Door and drawers in base and tall cabinets are grain matched vertically to assure grain continuity. Variations in grain and tone may occur and are not a cause for replacement.
- Radius doors not available.
- "Z" doors available.

#### ■ Glass Door: WGPW only.

## ■ PALERMO

### PLAIN



### RAISED

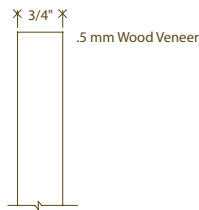

### STYLED

#### ■ Door Features:

- 11/16" MDF core with Exotic Veneer
- Available in ALL Exotic Veneers.
- Matching wood edges on all door and drawer
- Cabinet faces coordinating PVC, when available
- Radius and "Z" doors are available.
- Doors and drawer of base and tall cabinets are grain matched vertically.
- Backs of door have a slight grain variation from face.
- Refer to Exotic Veneer Selection Chart for veneer price groups.

#### ■ Glass Door: WGPW only.

EURO	Group I	Group II	Group III	Group IV	Group V
■ PRICE: Drawers	\$35	\$40	\$70	\$95	\$105
■ PRICE: Doors	\$155	\$165	\$295	\$410	\$465

## ■ NAPLES

### PLAIN

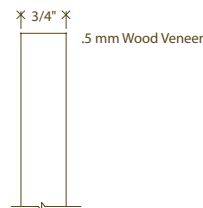

#### ■ Door Features:

- 11/16" MDF core with Exotic Veneer
- Available in Zebra Wood, European Steamed Beech, Ruff cut White Oak veneers only.
- Matching wood edges on all door and drawer
- Cabinet faces coordinating PVC, when available
- Radius and "Z" doors are available.
- Doors and drawer of base and tall cabinets are grain matched vertically.
- Each door/drawer face is unique. Exact grain match, horizontal door-to-door is not available. On double door cabinets grain will NOT match door-to-door.
- Backs of door have a slight grain variation from face.
- Refer to Exotic Veneer Selection Chart for veneer price groups.

#### ■ Glass Door: WGPW only.

EURO	Group I	Group II	Group III	Group IV	Group V
■ PRICE: Drawers	\$40	\$45	\$80	N/A	N/A
■ PRICE: Doors	\$175	\$185	\$340	N/A	N/A

## ■ LIGNA

### PLAIN



#### ■ Door Features:

- 1 1/16" MDF core with FORMICA LIGNA.
- Matching Ligna edges on all door, drawer and cabinet front edges.
- Maximum door size - 25" wide by 58" high.
- Radius and "Z" doors are available.
- Doors and drawer of base and tall cabinets are grain matched vertically.
- When finished face is ordered, back of doors and drawers will match cabinet interior.
- When finished interiors are ordered, backs of those cabinet doors and drawers will be finished.
- Refer Ligna Selections - chart for group pricing.

#### ■ Glass Door: WGPL only.

EURO	Group I	Group II	Group III
■ PRICE: Drawers	\$154	\$204	\$234
■ PRICE: Doors	\$222	\$320	\$446



■ || PITTSBURGH

PLAIN



<i>EURO</i>	<i>Plain</i>	<i>Raised</i>	<i>Styled</i>
■ <i>PRICE: Drawers</i>	\$458	x	x
■ <i>PRICE: Doors</i>	\$572		

■ **Door Features:**

- 20 gauge stainless steel single pan constructed door on wood core.
- Available in a brushed finish only.
- Back of doors and drawers are standard matching cabinet interiors with wood veneer, white or woodgrain laminate.
- Maximum door size - 24" wide by 48" high.
- Option: Back of doors and drawers available in stainless steel laminate. Add \$54 per each door and drawer.
- Radius and "Z" doors not available.

■ **Glass Door:** WGPSS only.

### ■ || MIAMI

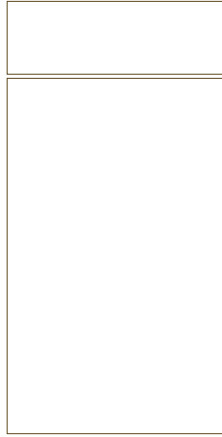

EURO	Plain	Raised	Styled
■ <b>PRICE: Drawers</b>	-\$18	x	x
■ <b>PRICE: Doors</b>	-\$18		

#### ■ **Door Features:**

- 11/16" low pressure laminate door with square PVC edges.
- Maximum door size - 25" wide by 58" high.
- Radius and "Z" doors not available.
- Available in white M49 only.

#### ■ **Glass Door:** WGPL only.

### ■ || MIAMI II

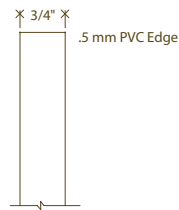
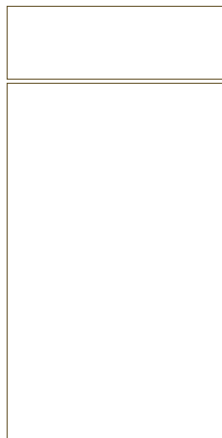

EURO	Plain	Raised	Styled
■ <b>PRICE: Drawers</b>	N/C	x	x
■ <b>PRICE: Doors</b>	N/C		

#### ■ **Door Features:**

- 11/16" high pressure laminate door with square PVC edges.
- Maximum door size - 25" wide by 58" high.
- Radius and "Z" doors available.
- Refer laminate selection charts.

#### ■ **Glass Door:** WGPL only.

### ORLANDO - V

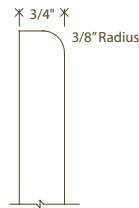
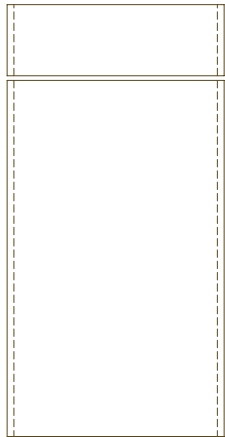

EURO	Plain	Raised	Styled
■ PRICE: Drawers	\$5	x	x
■ PRICE: Doors	\$15		

#### ■ Door Features:

- 11/16" MDF core.
- 90° radius on VERTICAL edges of doors and drawer heads. PVC on HORIZONTAL edges of doors and drawer heads.
- High pressure laminate on door face and back.
- Minimum width 5 7/8".
- Maximum door size - 25" wide by 58" high.
- Radius and "Z" doors not available.
- Doors, drawers and overlays less than 5 7/8" wide will have one square vertical edge.
- Refer laminate selection charts.

#### ■ Glass Door: WGPL only.

### ORLANDO - H

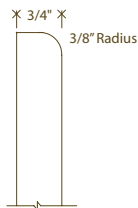
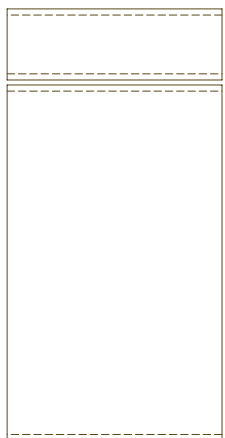

EURO	Plain	Raised	Styled
■ PRICE: Drawers	\$5	x	x
■ PRICE: Doors	\$5		

#### ■ Door Features:

- 11/16" MDF core.
- 90 degree radius on HORIZONTAL edges of doors and drawer heads. PVC on VERTICAL edges of doors and drawer heads.
- High pressure laminate on door face & back.
- Minimum width is 5 7/8".
- Maximum door size - 25" wide by 58" high.
- Refer laminate selection charts.
- Radius and "Z" doors not available.

#### ■ Glass Door: WGPL only.

### BOCA - V

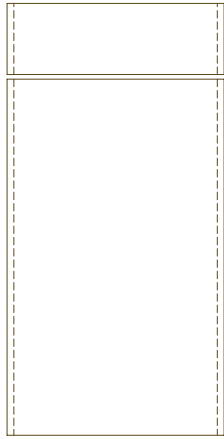

EURO	Plain	Raised	Styled
■ PRICE: Drawers	\$20	x	x
■ PRICE: Doors	\$20		

#### Door Features:

- 1 1/16" MDF core with 180° radius on VERTICAL edges of doors and drawer heads.
- PVC on HORIZONTAL edges of doors and drawer heads.
- High pressure laminate on door face and back.
- Minimum width 5 7/8".
- Maximum door size - 25" wide by 58" high.
- Doors, drawers and overlays less than 5 7/8" wide will have one square, vertical edge.
- Radius and "Z" doors not available.
- Refer laminate selections - finish section.

#### Glass Door: WGPL only.

### BOCA - H

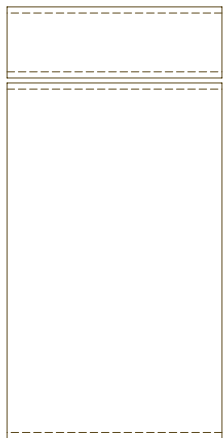

EURO	Plain	Raised	Styled
■ PRICE: Drawers	\$20	x	x
■ PRICE: Doors	\$20		

#### Door Features:

- 1 1/16" MDF core with 180° radius on HORIZONTAL edges of doors and drawer heads.
- PVC on VERTICAL edges of doors and drawer heads.
- High pressure laminate on door face and back.
- Minimum width 5 7/8".
- Maximum door size - 25" wide by 58" high.
- Radius and "Z" doors not available.
- Refer laminate selections - finish section.

#### Glass Door: WGPL only.

## PIAZZA

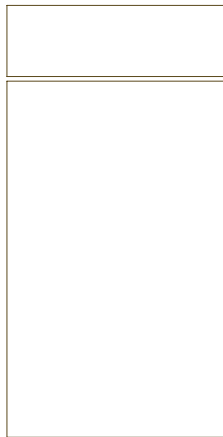

EURO	Group I	Group II	Group III	Group IV
■ PRICE: Drawers	\$15	\$18	N/A	N/A
■ PRICE: Doors	\$58	\$98	N/A	N/A

### ■ Door Features:

- 3/4" slab foil door with an eased foil edge.
- Foil edges on all door and drawer.
- Case faces coordinating PVC.
- Radius and "Z" doors are NOT available.
- Doors and drawer of base and tall cabinets are NOT grain matched vertically.
- When a foil with grain is selected the drawer fronts will have horizontal grain as standard.
- Backs of door will have white, grey melamine and wood grain to coordinate with interior of cabinet. Block will be supplied as (a) standard.
- Refer to the Trevisio foil selection chart for foil price groups.

### ■ Glass Door: WGPL only.

## PIAZZA ALU



EURO	Group I	Group II	Group III	Group IV
■ PRICE: Drawers	\$62	\$80	N/A	N/A
■ PRICE: Doors	\$234	\$291	N/A	N/A

### ■ Door Features:

- 3/4" slab foil door with 1 aluminum PVC edge.
- 2mm aluminum PVC on edges on all door and drawer
- Case faces coordinating PVC.
- Radius and "Z" doors are NOT available.
- Doors and drawer of base and tall cabinets are NOT grain matched vertically.
- When a foil with grain is selected the drawer fronts will have horizontal grain as standard.
- Backs of door will have white, black or wood grain melamine to coordinate with interior of cabinet. Black will be supplied as standard.
- Refer to the Trevisio foil selection chart for foil price groups.

### ■ Glass Door: WGPL only.

### BOCA - V

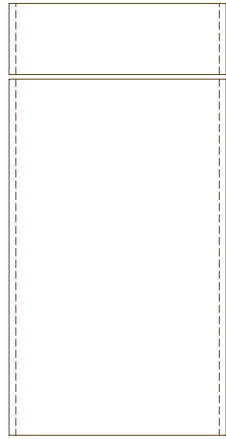

#### EURO

	Plain	Raised	Styled
■ PRICE: Drawers	\$20	x	x
■ PRICE: Doors	\$20		

#### ■ Door Features:

- 1 1/16" MDF core with 180° radius on VERTICAL edges of doors and drawer heads.
- PVC on HORIZONTAL edges of doors and drawer heads.
- High pressure laminate on door face and back.
- Minimum width 5 7/8".
- Maximum door size - 25" wide by 58" high.
- Doors, drawers and overlays less than 5 7/8" wide will have one square, vertical edge.
- Radius and "Z" doors not available.
- Refer laminate selections - finish section.

#### ■ Glass Door: WGPL only.

### BOCA - H

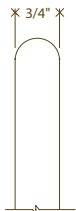
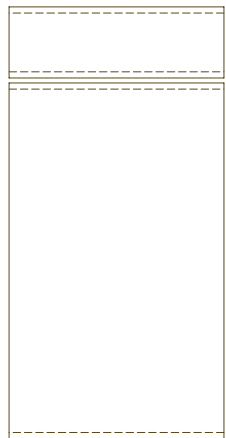

#### EURO

	Plain	Raised	Styled
■ PRICE: Drawers	\$20	x	x
■ PRICE: Doors	\$20		

#### ■ Door Features:

- 1 1/16" MDF core with 180° radius on HORIZONTAL edges of doors and drawer heads.
- PVC on VERTICAL edges of doors and drawer heads.
- High pressure laminate on door face and back.
- Minimum width 5 7/8".
- Maximum door size - 25" wide by 58" high.
- Radius and "Z" doors not available.
- Refer laminate selections - finish section.

#### ■ Glass Door: WGPL only.

### ■ || DOLCE'

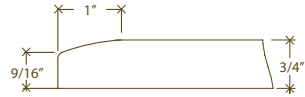
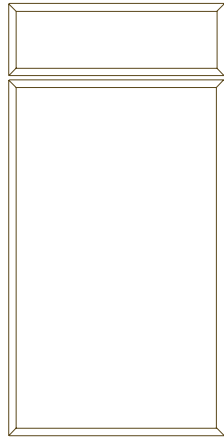

EURO	Group I	Group II	Group III	Group IV
■ PRICE: Drawers	\$18	\$24	N/A	N/A
■ PRICE: Doors	\$83	\$123	N/A	N/A

#### ■ Door Features:

- 3/4" slab foil with soft edge.
- Foil edges on all door and drawer.
- Case faces have coordinating PVC.
- Radius and "Z" doors are NOT available.
- Doors and drawer of base and tall cabinets are NOT grain matched vertically.
- When a foil with grain is selected the drawer fronts will have horizontal grain as standard.
- Backs of door will have white, black or wood grain melamine to coordinate with interior of cabinet. Black will be supplied as standard.
- Refer to the Trevisio foil selection chart for foil price group.

#### ■ Glass Door: WGPL only.

### ■ || RIGA SOLIDO

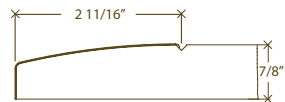
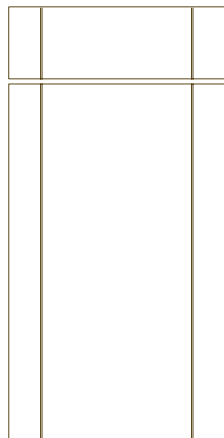

EURO	Group I	Group II	Group III	Group IV
■ PRICE: Drawers	\$77	\$90	N/A	N/A
■ PRICE: Doors	\$280	\$320	N/A	N/A

#### ■ Door Features:

- 3/4" foil with 2 1/2" tapered horizontal edges that are separated from center portion of door by a 1/16" "V" groove.
- Foil edges on all door and drawer.
- Case faces coordinating PVC.
- Radius and "Z" doors are NOT available.
- Doors and drawer of base and tall cabinets are NOT grain matched vertically.
- When a foil with grain is selected the drawer fronts will have horizontal grain as standard.
- Backs of door will have white, black or wood grain melamine to coordinate with interior of cabinet. Black will be supplied as standard.
- Refer to the Trevisio foil selection chart for foil price groups.

#### ■ Glass Door: WGPL only.

## ■|| CUPO BRILLARE

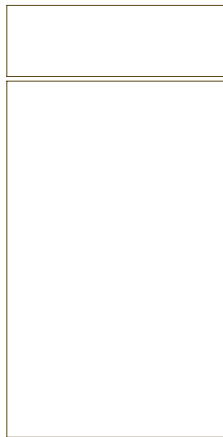

EURO	Group I	Group II	Group III	Group IV
■ PRICE: Drawers	N/A	N/A	\$73	\$95
■ PRICE: Doors	N/A	N/A	\$269	\$335

### ■ Door Features:

- 3/4" slab foil door with coordinating PVC edge.
  - The main feature of this glossy "mirror like" surface are its' exceptional brightness, enduring character and scratch & UV resistance.
  - .5mm PVC edges on all door and drawer
  - Case faces corrdinating PVC.
  - Radius and "Z" doors are NOT available.
  - Backs of door will have have coordinating melamine as standard.
  - Refer to the Trevisio foil selection chart for foil price groups.
- **Glass Door:** WGPL only.

## ■|| CUPO BRILLARE ALU

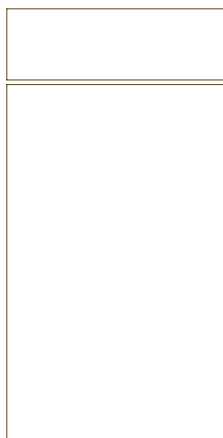

EURO	Group I	Group II	Group III	Group IV
■ PRICE: Drawers	N/A	N/A	\$78	\$99
■ PRICE: Doors	N/A	N/A	\$282	\$348

### ■ Door Features:

- 3/4" slab foil door with 2mm aluminum PVC edge.
  - The main feature of this glossy "mirror like" surface are its' exceptional brightness, enduring character and scratch & UV resistance.
  - 2mm aluminum PVC edges on all door and drawer
  - Case faces corrdinating PVC.
  - Radius and "Z" doors are NOT available.
  - Backs of door will have melamine to coordinate with face of door.
  - Refer to the Trevisio foil selection chart for foil price groups.
- **Glass Door:** WGPL only.



### ALU MINI GLASS

PLAIN

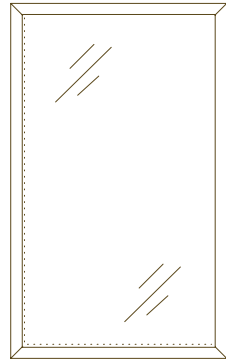

RAISED

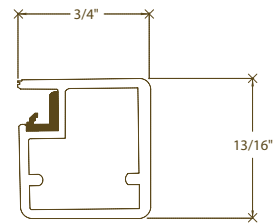

STYLED

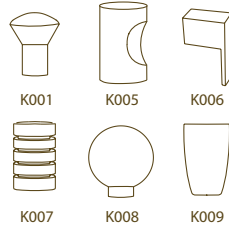

EURO

■ PRICE: Doors

Plain

■ PRICE: \$572

#### Door Features:

- Frame is machined to accept 5/32" (4mm) glass insert, included with frame.
- Glass availability is clear, frosted, reeded, matrix and strata, must specify.
- 3/4" frame width.
- All glass is tempered safety glass
- Door requirements- 4" Minimum 48" Maximum
- Finished interior must be ordered and will be charged for.
- Available in Natural Aluminum or Brushed Stainless
- Available in frameless construction only.
- Available Decorative Hardware Natural Anodized Aluminum knob or pull (must specify drilling location) See select hardware.
- Doors will be drilled for hardware. All hardware shipped loose.

### ALU MAXI GLASS

PLAIN

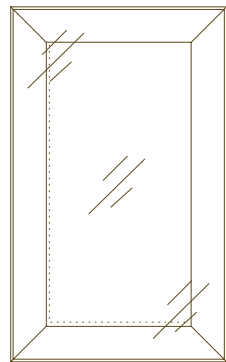

RAISED

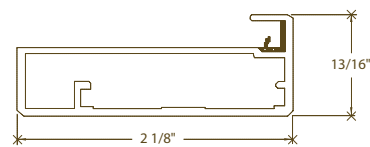

STYLED

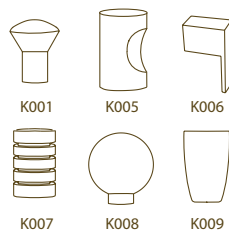

EURO

■ PRICE: Doors

Plain

■ PRICE: \$572

#### Door Features:

- Frame is machined to accept 5/32" (4mm) glass insert, included with frame.
- Glass availability is clear, frosted, reeded, matrix and strata, must specify.
- 2 1/8" frame width- 1/2" expose - 1 5/8" shadowed behind glass.
- All glass is tempered safety glass
- Door requirements- 5-1/2" Minimum 87-3/4" Maximum
- Finished interior must be ordered and will be charged for.
- Available in Natural Aluminum or Brushed Stainless
- Available in frameless construction only.
- Available Decorative Hardware Natural Anodized Aluminum knob or pull (must specify drilling location) See select hardware.
- Doors will be drilled for hardware. All hardware shipped loose.

## ■ || LAMINATE & VEENER FRAME DOOR

### PLAIN

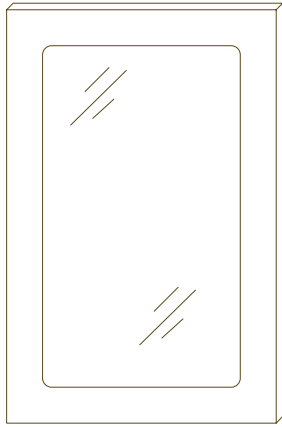

■ EURO DOORS:	Code	Price Premium
All doors listed above except Pittsburgh.	WGPL	\$126
Pittsburgh	WGPSS	\$622

### ■ Door Features:

- Available in Wall Street, Westchester, Columbia, Miami, Boca - H, Miami, Miami II, Boca - V, Boca H - C, Orlando - H, Orlando - V, Ligna, Ligna - Novanta, Pittsburgh, Palermo and Naples.
- One piece routed panel to accept 1/8" glass insert. Inside corners have 1/2" radius.
- 2 1/4" frame width.
- Interior of routed edge has coordinating PVC to match door edges.
- Not available on door over 42" high.
- Finished interiors must be ordered and will be charged.
- Glass not supplied.

## ■ || PW - WOOD FRAME DOOR

### PLAIN

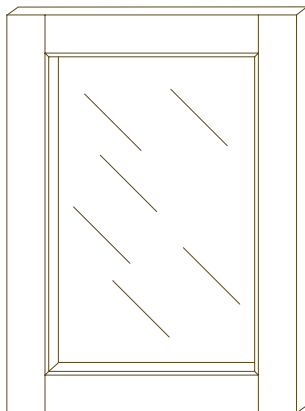

■ EURO DOORS:	Code	Price Premium
All	WGPW	\$128

### ■ Door Features:

- Available in Norfolk, Richmond, Cambridge, Arlington, Versailles, Birmingham, Franklin, Plymouth, Nantucket, Provincial, Turin, Milano, Genoa, Savona, Richland, Monticello, Roxbury, Geneva, Sonoma, Alexandria, Atherton, Vallejo, Saxony, Chesapeake, Augusta, Pittsfield, Koln, Bermen, Wall Street door styles.
- Four piece, 3/4" thick solid wood frame.
- Inside bead and outside lip will match door style specified.
- The frame is prepared to accept 1/8" glass with unique continuous clear plastic gasket.
- Doors on cabinets over 42" high receive a horizontal, centered intermediate door rail.
- Finished interiors must be ordered and will be charged.
- Euro glass not supplied.

**INS3 - SPEAKER CLOTH INSERT**

PLAIN

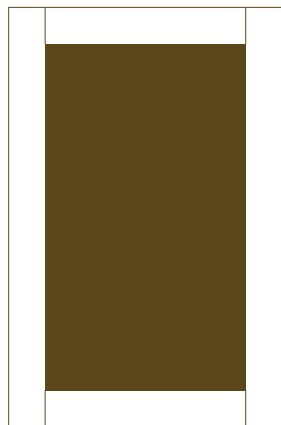

<b>EURO DOORS:</b>	<b>Code</b>	<b>Style Premium</b>
Per door plus door style	INS3	\$282

**Door Features:**

- Available in black speaker cloth only.
- Available in all doors with laminate and veneer frame door & wood frame door. See WGPW & WGPL for listing of doors.
- Cloth secured with wood retainer moulding.
- Standard interior automatically supplied.
- Order matching, finished interior if desired.

**MULLION FRAME DOOR**

PLAIN

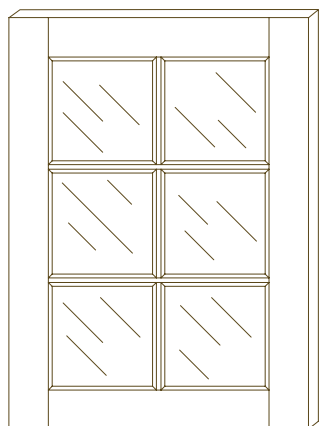

<b>CAB HEIGHT</b>	<b># Lites</b>	<b>Code</b>	<b>Style Premium</b>
■ 24" - 27"	4	WMD4	\$180
■ 30" - 36"	6	WMD6	\$192
■ 39" - 48"	8	WMD8	\$226
■ 54" - 60"	10	WMD10	\$260

**Door Features:**

- Available in Norfolk, Richmond, Cambridge, Arlington, Franklin, Nantucket, Provincial, Pittsfield, Chesapeake, Columbia, Reston
- Four piece, 3/4" thick solid wood.
- Inside bead and outer lip will match door style specified.
- Edges of mullions have decorative profile.
- The frame is prepared to accept 1/8" glass with continuous clear plastic gasket.
- Door of cabinets over 42" high receive a horizontal centered intermediate door rail.
- Glass not supplied.

## INS5 - ARTS AND CRAFTS DOOR

PLAIN

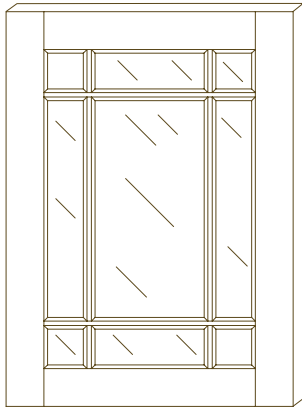

EURO DOORS:	Code	Style Premium
Per lite plus mullion door and style premium.	INS5	\$250

### Door Features:

- Standard interior supplied - order matching, finished interior if desired.
- Available in Norfolk, Richmond, Cambridge, Plymouth, Nantucket, Provincial and Arlington.
- 1/8" thick, double strength glass behind mullions.
- Nine lites each door regardless of height.
- Minimum cabinet height is 18".
- Minimum door width is 14 3/4".
- Corner lites are 2" x 2" - center. Section varies with height.
- Maximum single door height is 48".
- Only available in mortise & tenon doors.
- Glass not supplied.

## INS6 - PRAIRIE MULLION DOOR

PLAIN

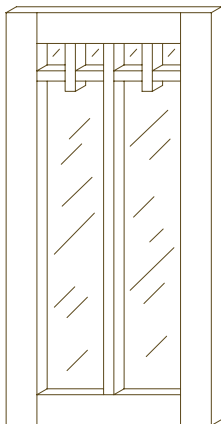

EURO DOORS:	Code	Style Premium
Per lite plus mullion door and style premium.	INS6	\$248

### Door Features:

- Standard interior supplied - order matching, finished interior if desired.
- Available in Norfolk, Richmond and Cambridge.
- 1/8" thick, double strength glass behind wood mullions.
- Minimum door width 14 3/4".
- Number of vertical mullions will vary as width of door increases.
- Only available in mortise & tenon doors.
- Maximum height is 48".
- Glass not supplied.

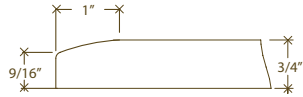
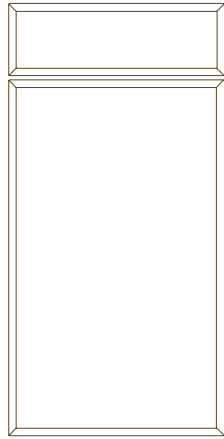
**■ || DOLCE'**

<i>EURO</i>	<i>Group I</i>	<i>Group II</i>	<i>Group III</i>	<i>Group IV</i>
■ <i>PRICE: Drawers</i>	\$18	\$24	N/A	N/A
■ <i>PRICE: Doors</i>	\$83	\$123	N/A	N/A

**■ Door Features:**

- 3/4" slab foil with soft edge.
- Foil edges on all door and drawer.
- Case faces have coordinating PVC.
- Radius and "Z" doors are NOT available.
- Doors and drawer of base and tall cabinets are NOT grain matched vertically.
- When a foil with grain is selected the drawer fronts will have horizontal grain as standard.
- Backs of door will have white, black or wood grain melamine to coordinate with interior of cabinet. Black will be supplied as standard.
- Refer to the Trevisio foil selection chart for foil price group.

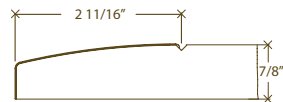
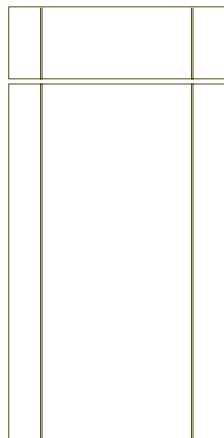
**■ Glass Door: WGPL only.**
**■ || RIGA SOLIDO**

<i>EURO</i>	<i>Group I</i>	<i>Group II</i>	<i>Group III</i>	<i>Group IV</i>
■ <i>PRICE: Drawers</i>	\$77	\$90	N/A	N/A
■ <i>PRICE: Doors</i>	\$280	\$320	N/A	N/A

**■ Door Features:**

- 3/4" foil with 2 1/2" tapered horizontal edges that are separated from center portion of door by a 1/16" "V" groove.
- Foil edges on all door and drawer.
- Case faces coordinating PVC.
- Radius and "Z" doors are NOT available.
- Doors and drawer of base and tall cabinets are NOT grain matched vertically.
- When a foil with grain is selected the drawer fronts will have horizontal grain as standard.
- Backs of door will have white, black or wood grain melamine to coordinate with interior of cabinet. Black will be supplied as standard.
- Refer to the Trevisio foil selection chart for foil price groups.

**■ Glass Door: WGPL only.**

## ■ || CUPO BRILLARE

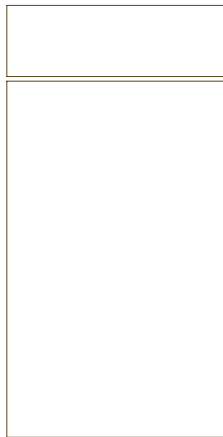

EURO	Group I	Group II	Group III	Group IV
■ PRICE: Drawers	N/A	N/A	\$73	\$95
■ PRICE: Doors	N/A	N/A	\$269	\$335

### ■ Door Features:

- 3/4" slab foil door with coordinating PVC edge.
- The main feature of this glossy "mirror like" surface are its' exceptional brightness, enduring character and scratch & UV resistance.
- .5mm PVC edges on all door and drawer
- Case faces corrdinating PVC.
- Radius and "Z" doors are NOT available.
- Backs of door will have have coordinating melamine as standard.
- Refer to the Trevisio foil selection chart for foil price groups.

### ■ Glass Door: WGPL only.

## ■ || CUPO BRILLARE ALU

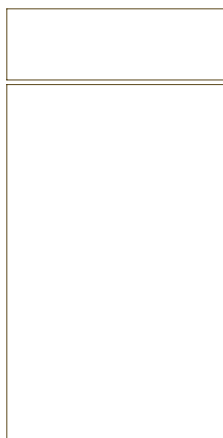

EURO	Group I	Group II	Group III	Group IV
■ PRICE: Drawers	N/A	N/A	\$78	\$99
■ PRICE: Doors	N/A	N/A	\$282	\$348

### ■ Door Features:

- 3/4" slab foil door with 2mm aluminum PVC edge.
- The main feature of this glossy "mirror like" surface are its' exceptional brightness, enduring character and scratch & UV resistance.
- 2mm aluminum PVC edges on all door and drawer
- Case faces corrdinating PVC.
- Radius and "Z" doors are NOT available.
- Backs of door will have melamine to coordinate with face of door.
- Refer to the Trevisio foil selection chart for foil price groups.

### ■ Glass Door: WGPL only.

### ALU MINI GLASS

PLAIN

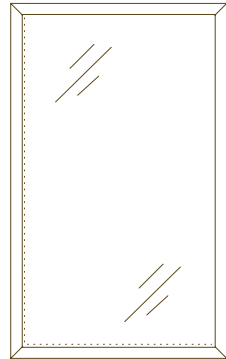

RAISED

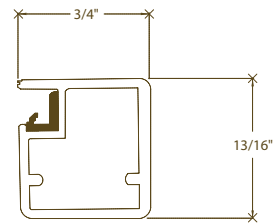

STYLED

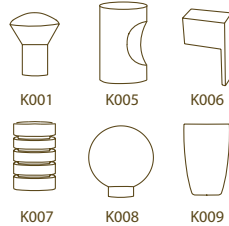

EURO

■ PRICE: Doors

Plain

■ PRICE: \$572

#### Door Features:

- Frame is machined to accept 5/32" (4mm) glass insert, included with frame.
- Glass availability is clear, frosted, reeded, matrix and strata, must specify.
- 3/4" frame width.
- All glass is tempered safety glass
- Door requirements- 4" Minimum 48" Maximum
- Finished interior must be ordered and will be charged for.
- Available in Natural Aluminum or Brushed Stainless
- Available in frameless construction only.
- Available Decorative Hardware Natural Anodized Aluminum knob or pull (must specify drilling location) See select hardware.
- Doors will be drilled for hardware. All hardware shipped loose.

### ALU MAXI GLASS

PLAIN

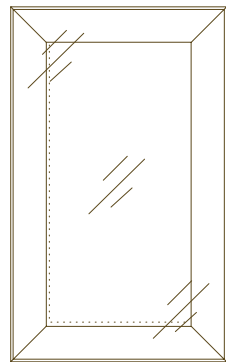

RAISED

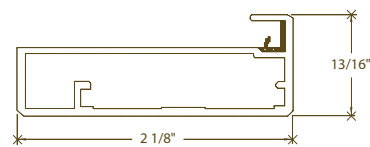

STYLED

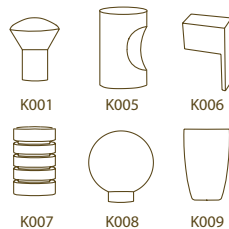

EURO

■ PRICE: Doors

Plain

■ PRICE: \$572

#### Door Features:

- Frame is machined to accept 5/32" (4mm) glass insert, included with frame.
- Glass availability is clear, frosted, reeded, matrix and strata, must specify.
- 2 1/8" frame width- 1/2" expose - 1 5/8" shadowed behind glass.
- All glass is tempered safety glass
- Door requirements- 5-1/2" Minimum 87-3/4" Maximum
- Finished interior must be ordered and will be charged for.
- Available in Natural Aluminum or Brushed Stainless
- Available in frameless construction only.
- Available Decorative Hardware Natural Anodized Aluminum knob or pull (must specify drilling location) See select hardware.
- Doors will be drilled for hardware. All hardware shipped loose.

## ■ || LAMINATE & VEENER FRAME DOOR

### PLAIN

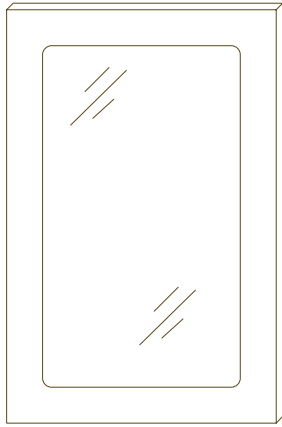

■ EURO DOORS:	Code	Price Premium
All doors listed above except Pittsburgh.	WGPL	\$126
Pittsburgh	WGPSS	\$622

### ■ Door Features:

- Available in Wall Street, Westchester, Columbia, Miami, Boca - H, Miami, Miami II, Boca - V, Boca H - C, Orlando - H, Orlando - V, Ligna, Ligna - Novanta, Pittsburgh, Palermo and Naples.
- One piece routed panel to accept 1/8" glass insert. Inside corners have 1/2" radius.
- 2 1/4" frame width.
- Interior of routed edge has coordinating PVC to match door edges.
- Not available on door over 42" high.
- Finished interiors must be ordered and will be charged.
- Glass not supplied.

## ■ || PW - WOOD FRAME DOOR

### PLAIN

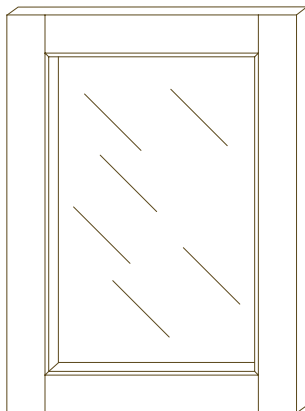

■ EURO DOORS:	Code	Price Premium
All	WGPW	\$128

### ■ Door Features:

- Available in Norfolk, Richmond, Cambridge, Arlington, Versailles, Birmingham, Franklin, Plymouth, Nantucket, Provincial, Turin, Milano, Genoa, Savona, Richland, Monticello, Roxbury, Geneva, Sonoma, Alexandria, Atherton, Vallejo, Saxony, Chesapeake, Augusta, Pittsfield, Koln, Bermen, Wall Street door styles.
- Four piece, 3/4" thick solid wood frame.
- Inside bead and outside lip will match door style specified.
- The frame is prepared to accept 1/8" glass with unique continuous clear plastic gasket.
- Doors on cabinets over 42" high receive a horizontal, centered intermediate door rail.
- Finished interiors must be ordered and will be charged.
- Euro glass not supplied.



### ■ || INS3 - SPEAKER CLOTH INSERT

PLAIN

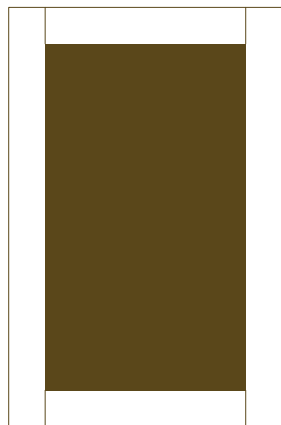

■ EURO DOORS:	Code	Style Premium
Per door plus door style	INS3	\$282

#### ■ Door Features:

- Available in black speaker cloth only.
- Available in all doors with laminate and veneer frame door & wood frame door. See WGPW & WGPL for listing of doors.
- Cloth secured with wood retainer moulding.
- Standard interior automatically supplied.
- Order matching, finished interior if desired.

### ■ || MULLION FRAME DOOR

PLAIN

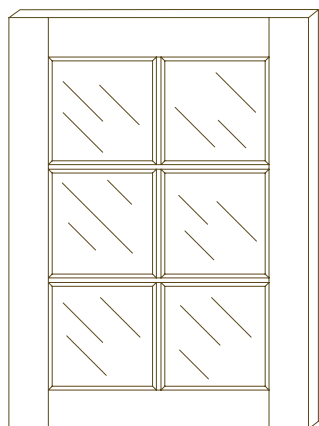

CAB HEIGHT	# Lites	Code	Style Premium
■ 24" - 27"	4	WMD4	\$180
■ 30" - 36"	6	WMD6	\$192
■ 39" - 48"	8	WMD8	\$226
■ 54" - 60"	10	WMD10	\$260

#### ■ Door Features:

- Available in Norfolk, Richmond, Cambridge, Arlington, Franklin, Nantucket, Provincial, Pittsfield, Chesapeake, Columbia, Reston
- Four piece, 3/4" thick solid wood.
- Inside bead and outer lip will match door style specified.
- Edges of mullions have decorative profile.
- The frame is prepared to accept 1/8" glass with continuous clear plastic gasket.
- Door of cabinets over 42" high receive a horizontal centered intermediate door rail.
- Glass not supplied.

## INS5 - ARTS AND CRAFTS DOOR

PLAIN

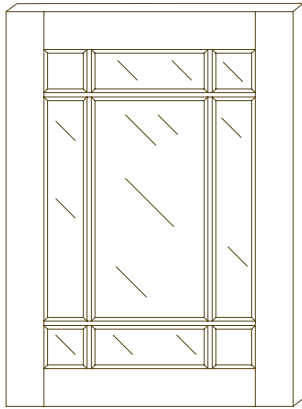

EURO DOORS:	Code	Style Premium
Per lite plus mullion door and style premium.	INS5	\$250

### Door Features:

- Standard interior supplied - order matching, finished interior if desired.
- Available in Norfolk, Richmond, Cambridge, Plymouth, Nantucket, Provincial and Arlington.
- 1/8" thick, double strength glass behind mullions.
- Nine lites each door regardless of height.
- Minimum cabinet height is 18".
- Minimum door width is 14 3/4".
- Corner lites are 2" x 2" - center. Section varies with height.
- Maximum single door height is 48".
- Only available in mortise & tenon doors.
- Glass not supplied.

## INS6 - PRAIRIE MULLION DOOR

PLAIN

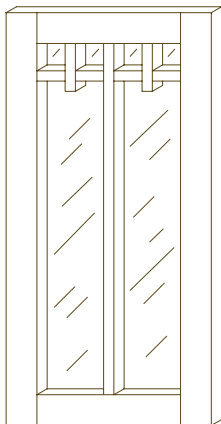

EURO DOORS:	Code	Style Premium
Per lite plus mullion door and style premium.	INS6	\$248

### Door Features:

- Standard interior supplied - order matching, finished interior if desired.
- Available in Norfolk, Richmond and Cambridge.
- 1/8" thick, double strength glass behind wood mullions.
- Minimum door width 14 3/4".
- Number of vertical mullions will vary as width of door increases.
- Only available in mortise & tenon doors.
- Maximum height is 48".
- Glass not supplied.